



E L E

N K

E R

HEAVY DUTY  
ROLLATOR  
WALKER

HEAVY DUTY  
ROLLATOR  
WALKER



# USER MANUAL

## Parts:



- 1 Handgrip
- 2 Backrest
- 3 Under-seat Basket
- 4 Cane Holder
- 5 Front Wheel

- 6 Handbrake
- 7 Cup Holder
- 8 Padded Seat
- 9 Rear Wheel

# SET-UP INSTRUCTIONS

## STEP 1

Unbox the walker on a level floor.



## Accessories



1x Cane holder



1x Cup holder



1x "8" Shape hook and loop strap for cane

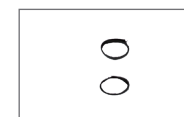

2x Hook and loop straps for brake cables

## STEP 2

### Front Wheels Assembly

Press spring button of wheel's leg, then insert it into the main frame(fig 2,2-1). The same steps to assemble right front wheel's leg(there are labels on leg and the main frame "L1-L1 R1-R1")(fig 2-2).

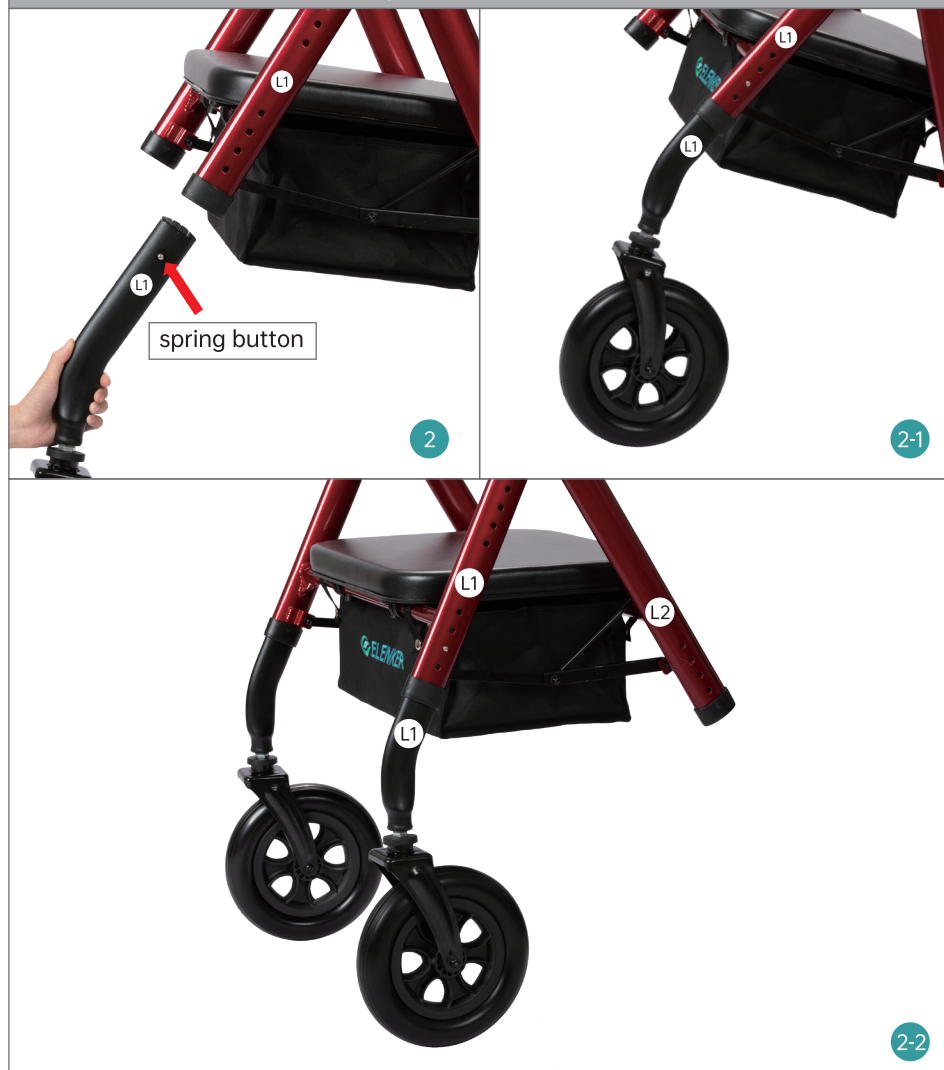

## STEP 3

### Rear Wheels Assembly

Press spring button of wheel's leg, then insert it into the main frame(fig 3,3-1). The same step to assemble right rear wheel's leg(there are labels on leg and the main frame "L2-L2 R2-R2")(fig 3-2).



## STEP 4

### Handle Bar Assembly

Press spring button of handle bar, then insert it into the main frame(fig 4,4-1)  
(there are labels on leg and the main frame "L3-L3 R3-R3").

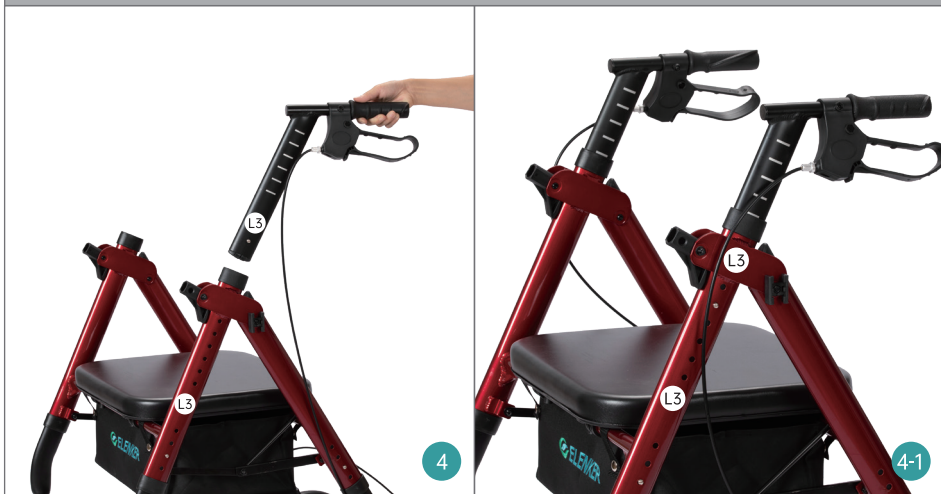

## STEP 5

### Backrest Assembly

Insert backrest into the main frame(fig 5, 5-1).

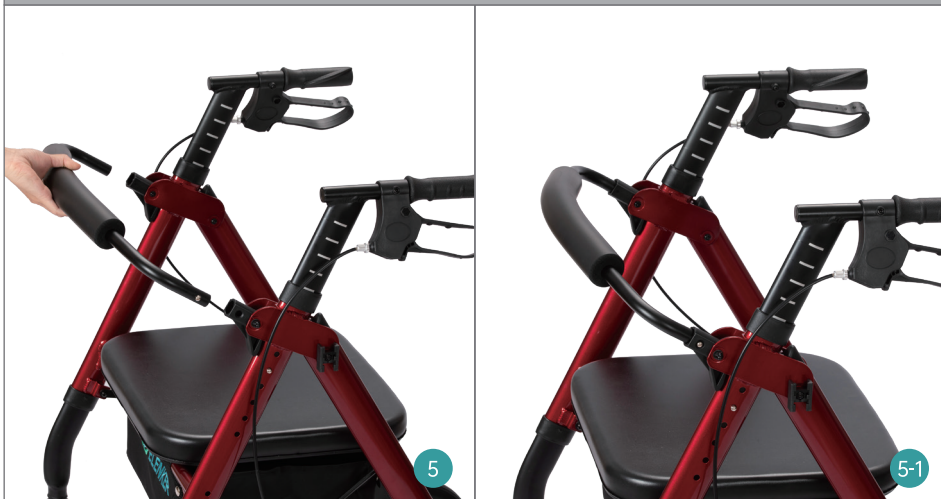

## STEP 6

### Brake Cable Hook and Loop Strap Assembly

Affix the brake cable to the main frame with hook and loop strap(fig 6).



## STEP 7

### Cane/Umbrella Holder Assembly

Insert cane holder into cane knob(Cane knob is on the left leg tube)(fig 7,7-1).  
Then affix the "8" shape hook and loop strap for securing the upper part of cane.

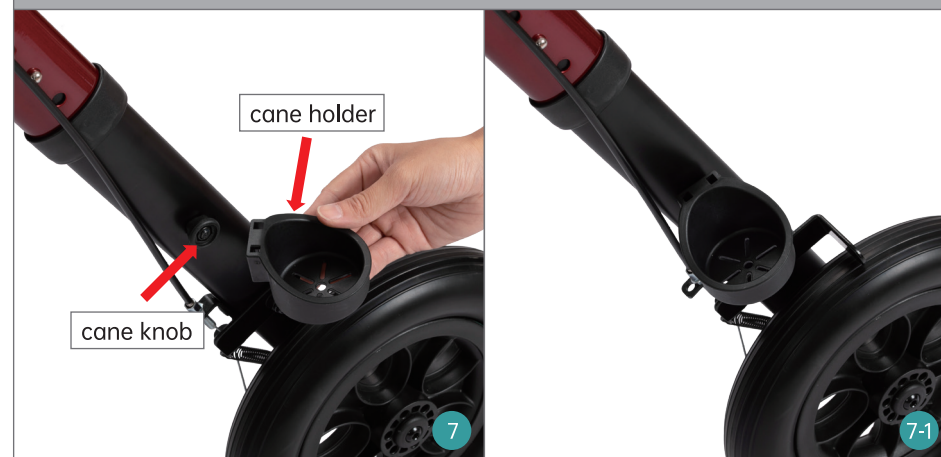





## STEP 8 Cup Holder Assembly

Affix cup holder on right handle bar(fig 8).

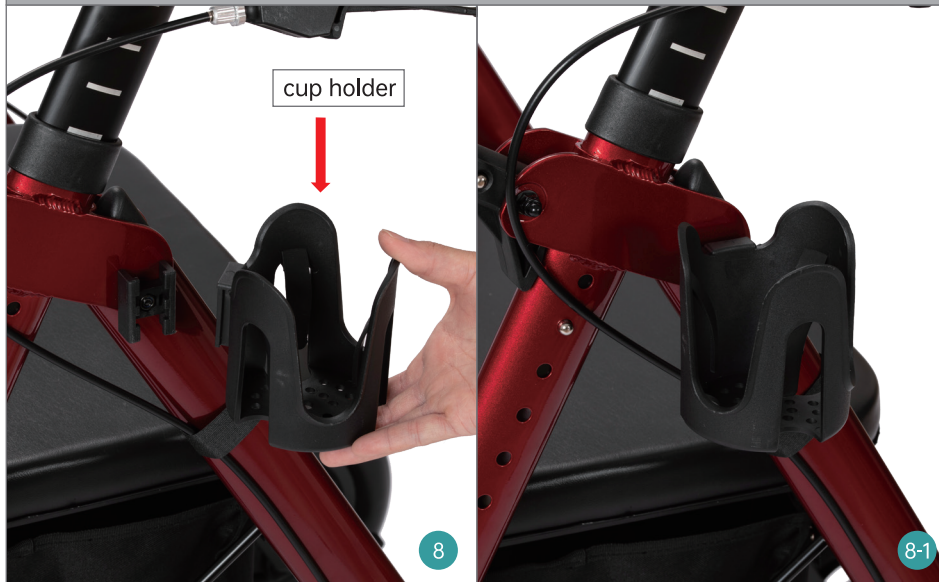

## The Curb Climber

Use it to overcome obstacles such as curbs and thresholds.



## HANDBRAKES OPERATION

1. Squeeze to slow
2. Push down to lock the rear wheels



## ONE-HAND FOLDING

Pull up the under-seat bracket to fold the walker.



## HOW TO ADJUST BRAKES

Brake Issue: The brake cannot engage rear wheel when squeezing handbrake (fig A).



### Adjust Rear Brake Position

Tools: Plier or 10mm wrench (fig 1).

Use plier(or 10mm wrench) to turn M6 nut counter-clockwise(fig 2-3). And brake will be closer to wheel(fig 4). Then squeeze handbrake, if it doesn't work, repeat the steps until rear brake can engage wheel.

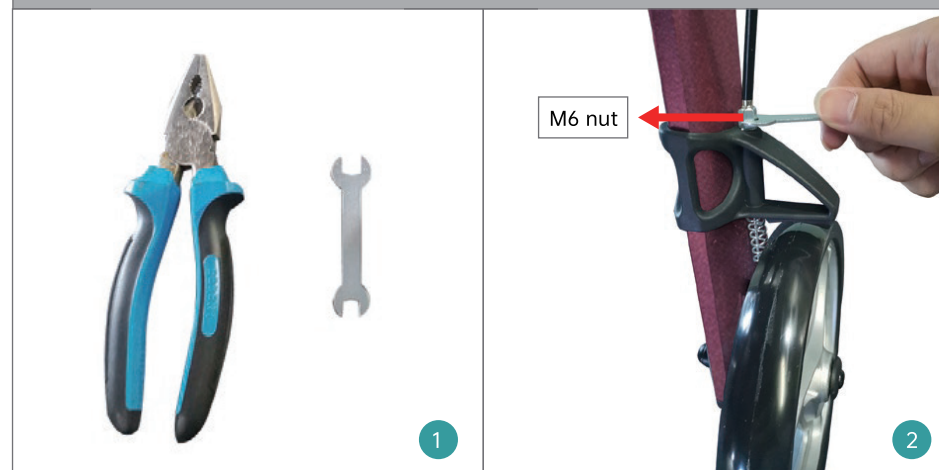

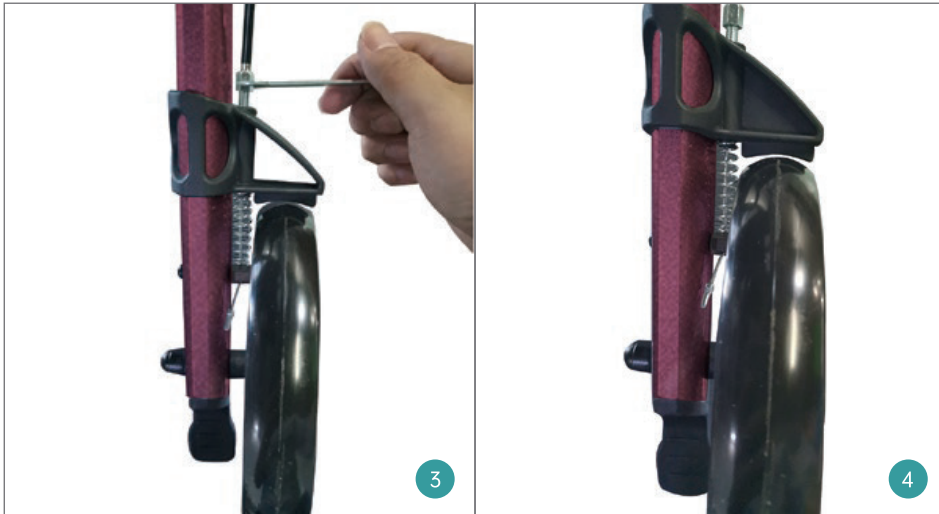

## CONTACT US

For any defects, parts missing, use or repair concerning our products, please contact us first, our customer service will reply within 24 hours and offer a good solution. Thank you for your support.





1. E-mail: [service@elenker.com](mailto:service@elenker.com)
2. Amazon Message: Click the Sold by "store name" under the buy box, then "ask a question". (Amazon Buyer)
3. Customer Help Line: 800-513-5727
4. Victor, 1885 Vineyard Avenue Building 16 Unit 3  
Ontario, CA 91761 United States.

## WARRANTY

- \* You may return most new, unopened items sold and fulfilled by Amazon within **30** days of delivery for a full refund.
- \* Defects in material accessories and non-durable components such as wheels, brakes, seat, handgrips and under NORMAL use for the **lifetime** warranty of the original consumer purchaser.
- \* The warranty does not extend to device failure due to owner misuse or negligence, or normal wear, tear and need periodic replacement.
- \* During warranty periods, our warranties cover all parts labor and shipping for repairing this walker.

## WARNINGS

To ensure your safety in using ELENKER Rollator Walker, all the following instructions must be followed

-  The maximum load of the walker is 500lbs.
-  DO NOT use walker, if there is apparent damage or if any parts are missing.
-  Ensure that brakes, height adjustment bolts or any other moving parts are in good condition and check all screws and fasteners, and retighten if necessary.
-  DO NOT use on stairs, escalators, moving sidewalks, or go up or down inclines greater than 15% or diagonally across inclines greater than 5%.
-  Be careful to avoid pinching your fingers while raising and lowering the handle bar and opening and closing the rollator walker frame.