



E L E

N K

E R

HFK-9210KD-3
ROLLATOR
WALKER

HFK-9210KD-3
ROLLATOR
WALKER



USER MANUAL

Parts:

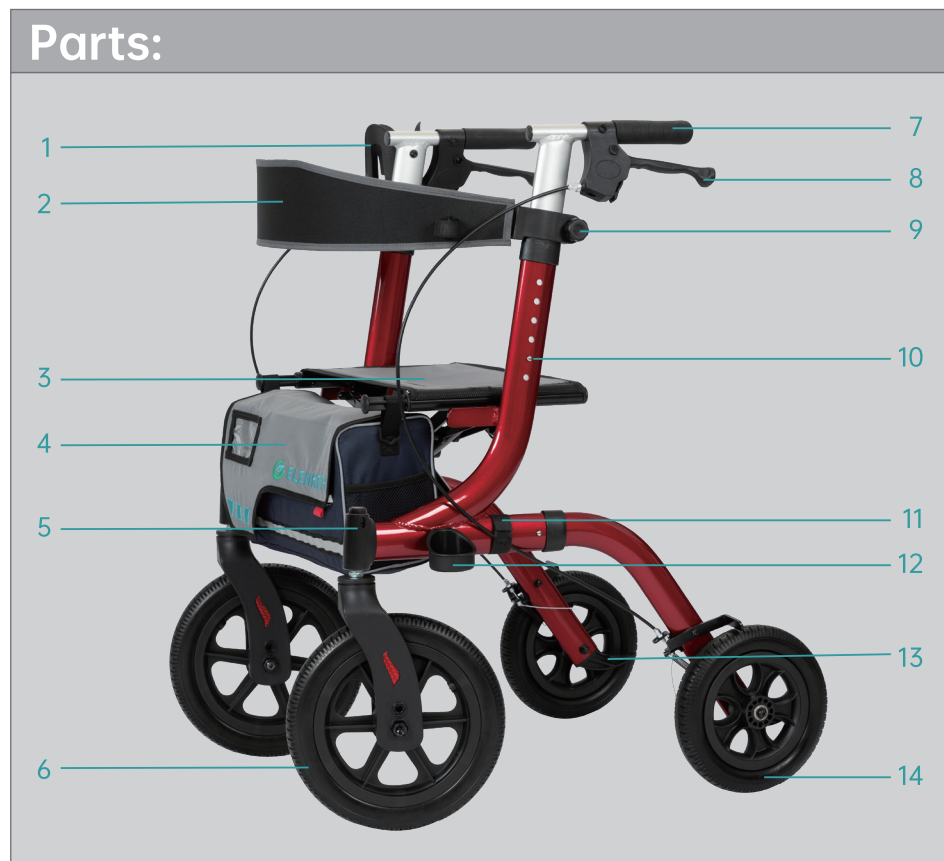

- | | |
|-------------------|---------------------------------------|
| 1 Cup holder | 8 Handbrake |
| 2 Backrest | 9 Knob of the backrest |
| 3 Seat | 10 Spring button |
| 4 Storage bag | 11 Hook and loop strap of brake cable |
| 5 Release button | 12 Cane holder |
| 6 12" front wheel | 13 The curb climber |
| 7 Handgrip | 14 10" rear wheel |

SET-UP INSTRUCTIONS



ACCESSORIES LIST



1x Hook and loop strap of brake cable



1x Cane holder



1x Cup holder

STEP 1 Front Wheels Assembly

Insert the wheel into the main frame(fig 1, 1-1), make sure the hexagon head insert into the plastic socket(fig 1-2, 1-3, 1-4), the same steps to assemble the other front wheel(fig 1-5). (There are labels on each tube "L1-L1,R1-R1").

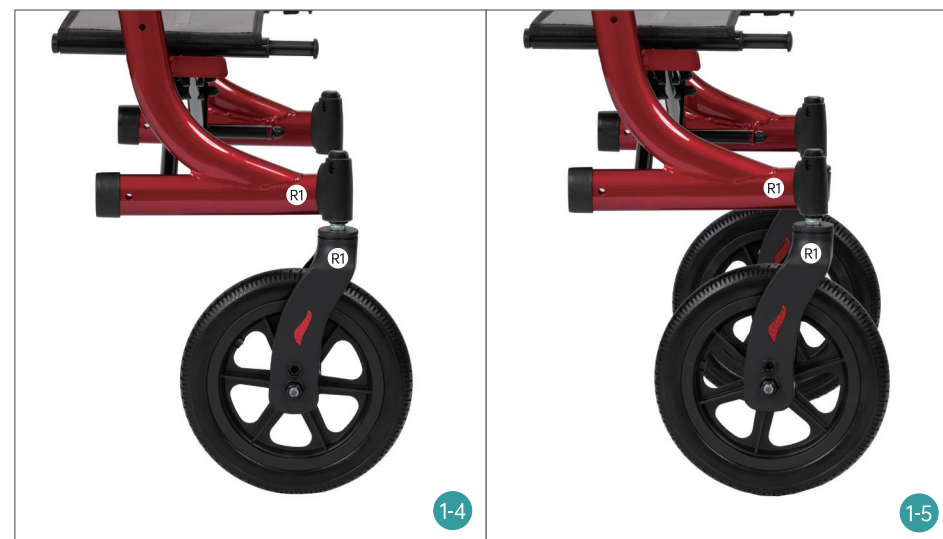
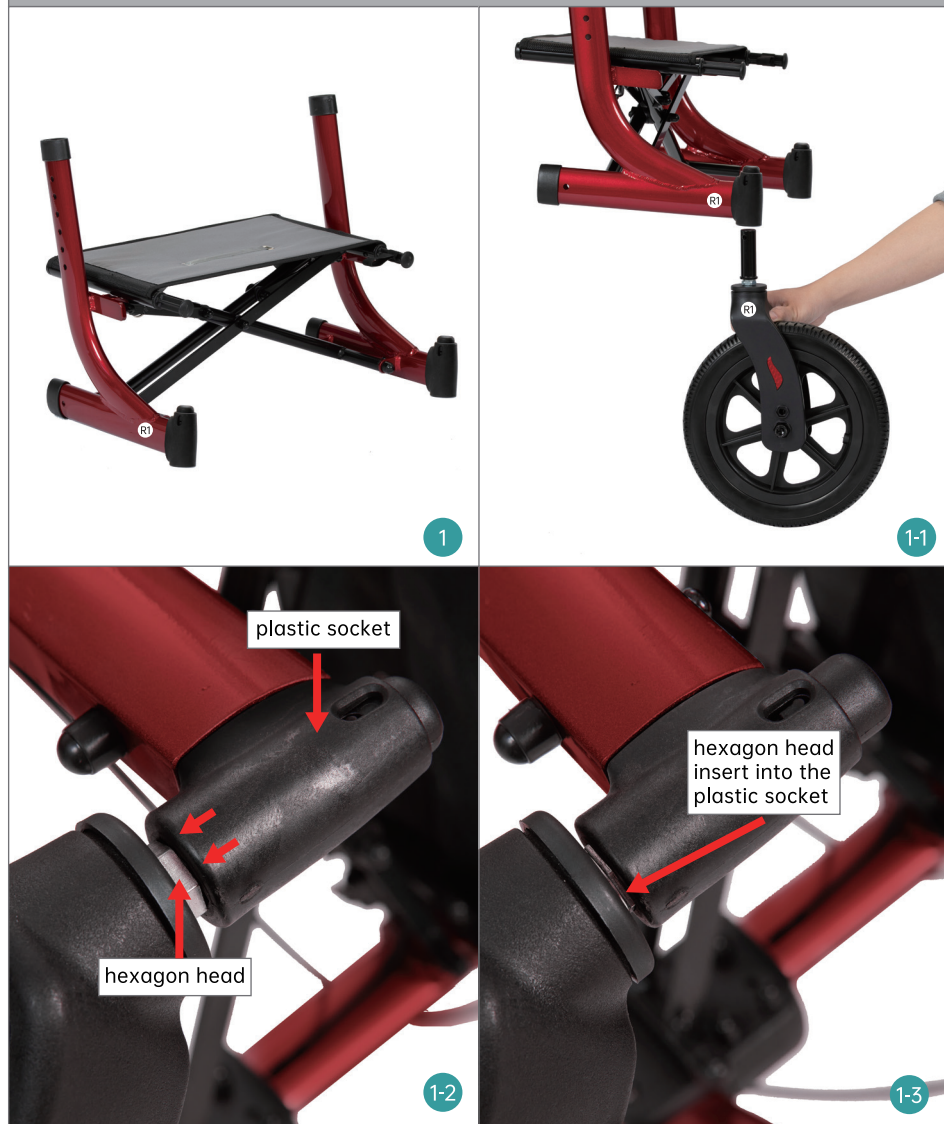

STEP 2 Rear Wheels Assembly

Remove the plug before installing (fig 2, 2-1), press the spring button of the wheel tube(fig 2-2), then insert the rear wheel tube into the rear main frame tube(fig 2-3). There are labels on tube, "L1-L1, R1-R1". Then insert the knob to secure the rear wheel tube in place(fig 2-4).

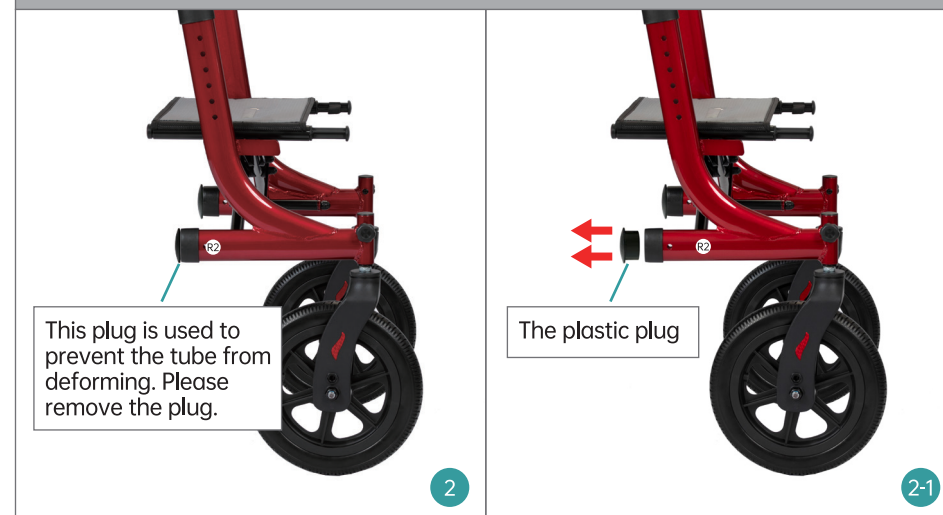



STEP 3

Handle Bars Assembly

Press spring button of the handle bar tube, then insert it into the main frame (fig 3,3-1). Repeat the same steps on the other side(fig 3-2)(There are labels on each tube"L3-L3, R3-R3").

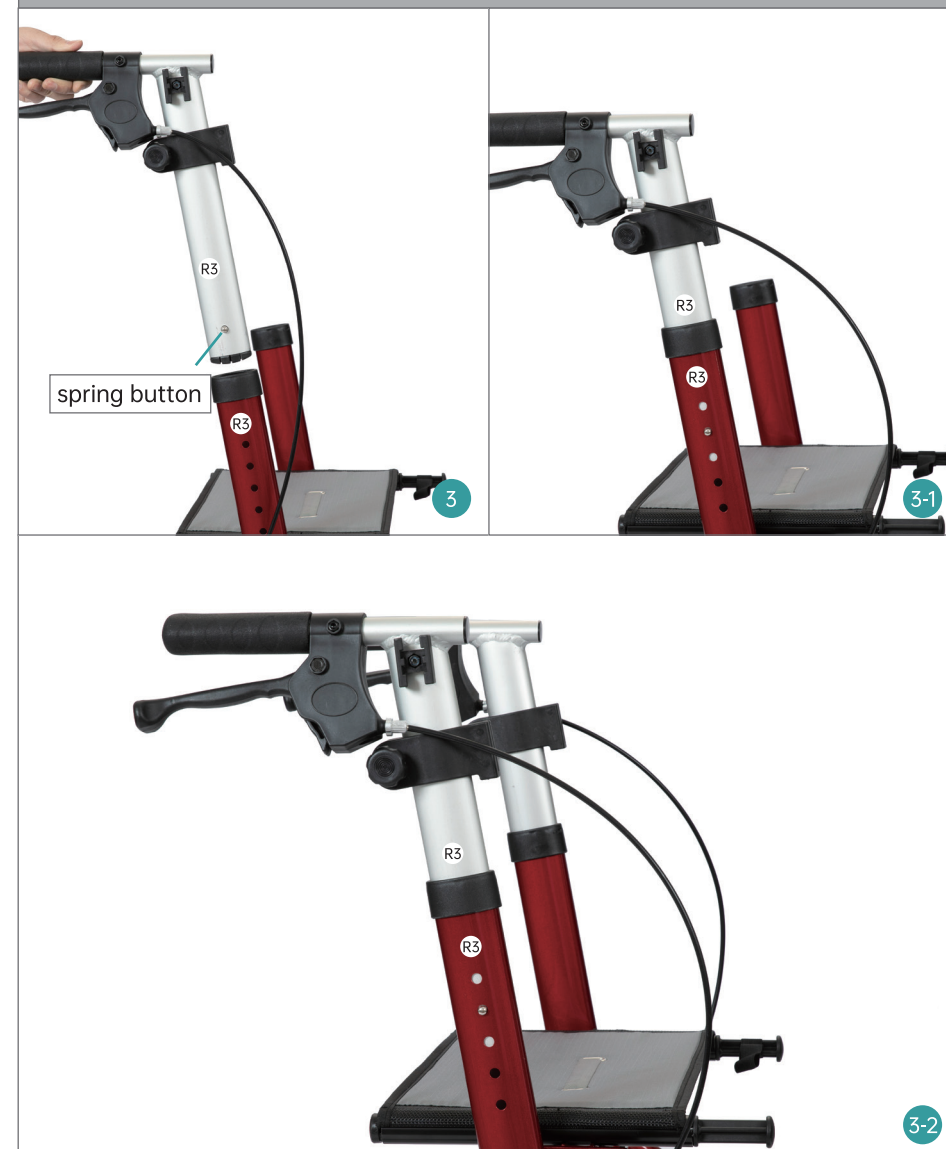

STEP 4

Backrest Assembly

Insert the backrest into the slot of backrest(fig 4,4-1), you can set your desired height of backrest and secure the backrest with the knob(fig 4-2).

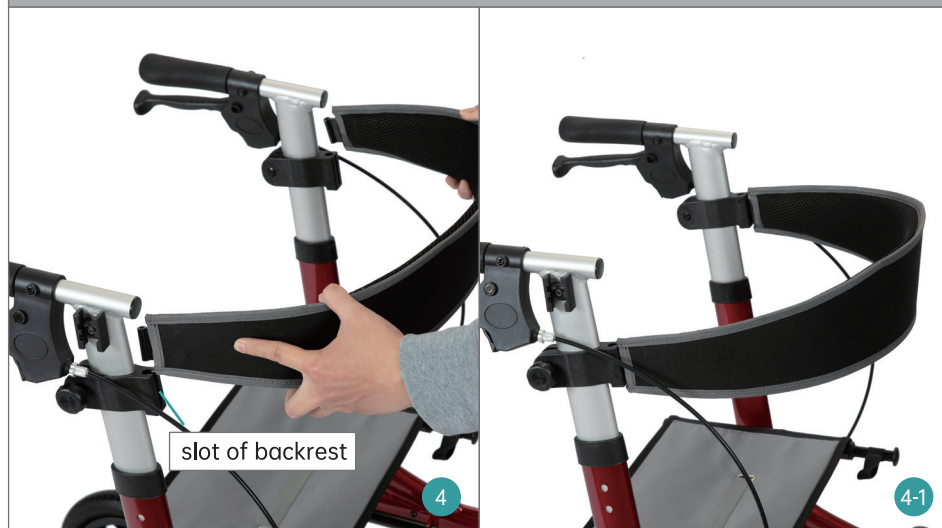

STEP 5

Storage Bag Assembly

Hang the bag on the stick of seat(fig 5,5-1).

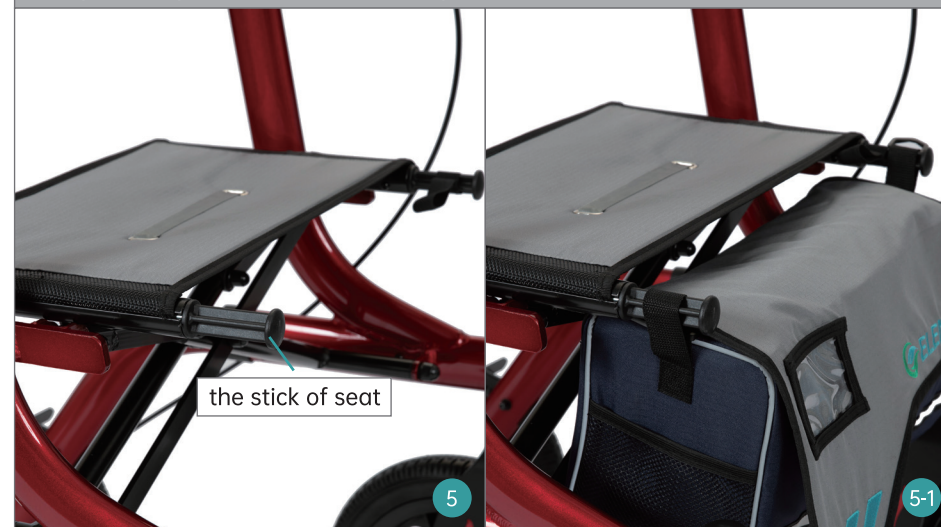

STEP 6

Cup Holder Assembly

The right side of handle bar has a slot(fig 6), insert the cup holder into the slot (fig 6-1).

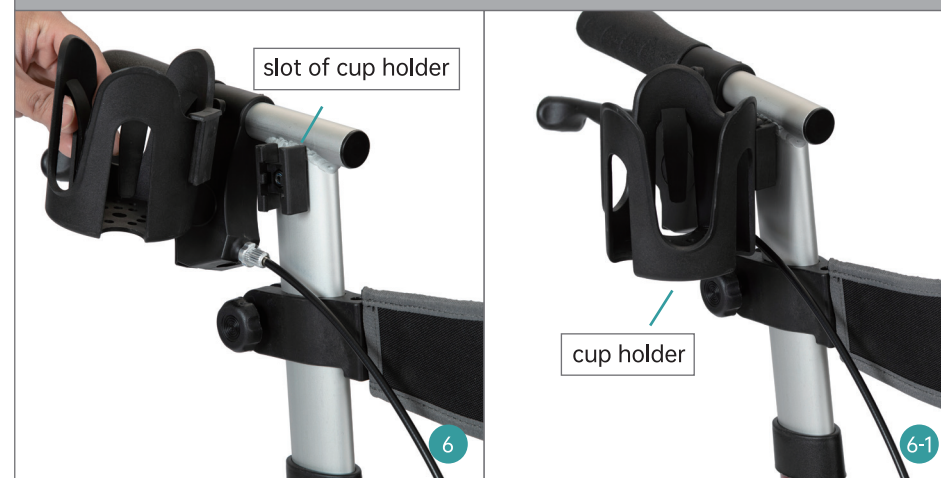

STEP 7

Cane Holder Assembly

The left side of leg has a knob(fig 7), insert the cane holder into the knob (fig 7-1).

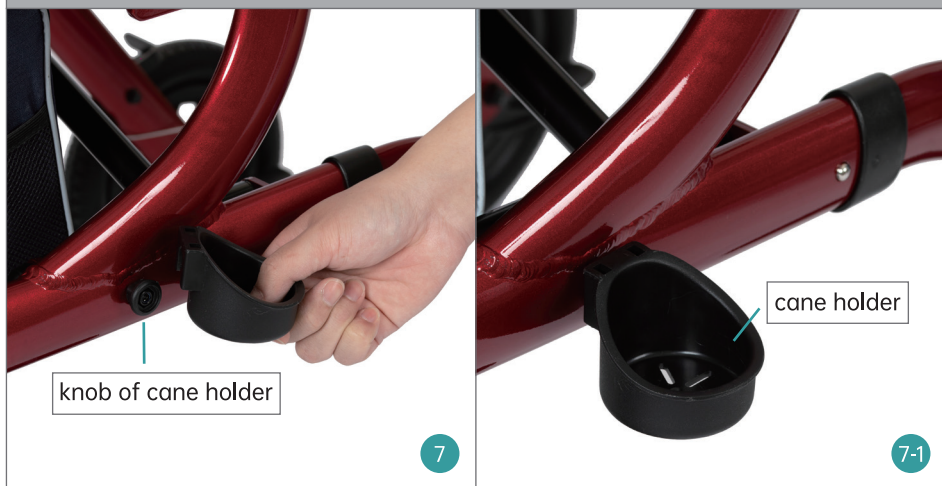

STEP 8

Organize Brake Cable

Affix brake cable to the main frame with hook and loop strap(fig 8).



THE CURB CLIMBER

Use it to overcome obstacles such as curbs and thresholds.



ONE-HAND FOLDING

Pull up strap of the seat to fold the walker, and secure it with the elastic loop band.



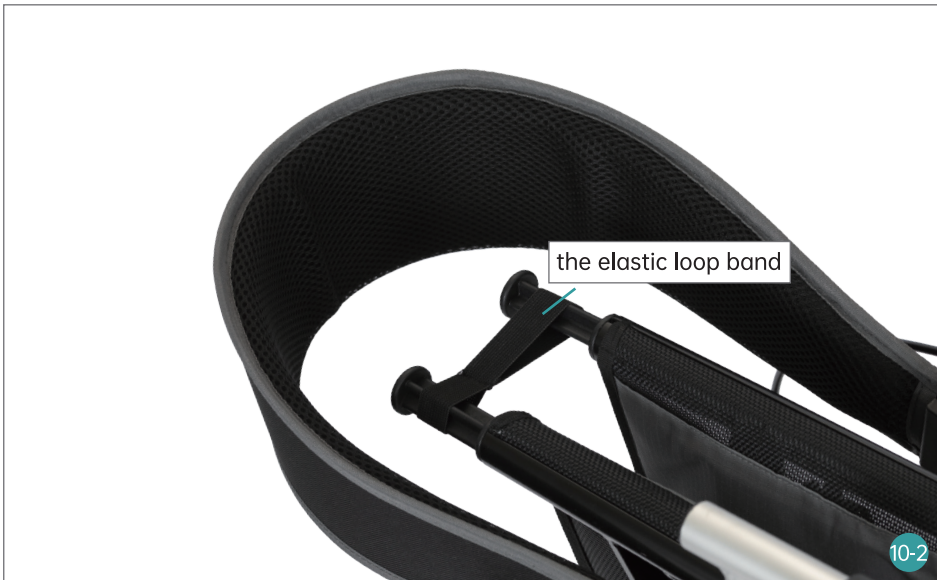

HANDBRAKES OPERATION

1. Squeeze to slow
2. Push down to lock the rear wheels.



CONTACT US

For any defects, parts missing, use or repair concerning our products, please contact us first, our customer service will reply within 24 hours and offer a good solution. Thank you for your support.





1. E-mail: elenkerservice@hotmail.com
2. Amazon Message: Click the Sold by "store name" under the buy box, than "ask a question". (Amazon Buyer)
3. Customer Help Line: (800) 401-7769

WARRANTY

- * You may return most new, unopened items sold and fulfilled by Amazon within **30** days of delivery for a full refund.
- * Defects in material accessories and non-durable components such as wheels, brakes, handgrips and under NORMAL use for the **lifetime** warranty of the original consumer purchaser.
- * The warranty does not extend to device failure due to owner misuse or negligence, or normal wear, tear and need periodic replacement.
- * During warranty periods, our warranties cover all parts labor and shipping for repairing this walker.

WARNINGS

To ensure your safety in using ELENKER Rollator Walker, all the following instructions must be followed

-  The maximum load of the walker is 300lbs.
-  DO NOT use walker, if there is apparent damage or if any parts are missing.
-  Ensure that brakes, height adjustment bolts or any other moving parts are in good condition and check all screws and fasteners, and retighten if necessary.
-  DO NOT use on stairs, escalators, moving sidewalks, or go up or down inclines greater than 15% or diagonally across inclines greater than 5%.
-  Be careful to avoid pinching your fingers while raising and lowering the handle bar and opening and closing the rollator walker frame.