



E L E

N K

E R

HFK-9210KDB-3
ROLLATOR
WALKER

HFK-9210KDB-3
ROLLATOR
WALKER



USER MANUAL

Parts:



- | | |
|------------------------|----------------------------|
| 1 Handbrake | 7 Handgrip |
| 2 Handgrip Clamp Lever | 8 Armrest Pad |
| 3 Backrest | 9 Height Adjustment Button |
| 4 Seat | 10 Sit-to-stand Handle Bar |
| 5 Storage Bag | 11 Cane Holder |
| 6 Front Wheel | 12 Rear Wheel |

SET-UP INSTRUCTIONS

STEP 1

Unbox the walker on a level floor.



ACCESSORIES LIST



1x Cane Holder



1x Cup Holder



2x Shorter
Nuts+Bolts



2x Knobs

STEP 2

Walker's Wheel Assembly

Take out the main frame, open it and press the seat down to be locked (fig 2).

Front Wheel Assembly

Insert the front wheel into the socket of main frame (fig 2-1), make sure the hexagon head insert into the plastic socket (fig 2-2, 2-3). The same steps to assemble the other front wheel (fig 2-4). There are labels "L1-L1, R1-R1" on each leg tube.

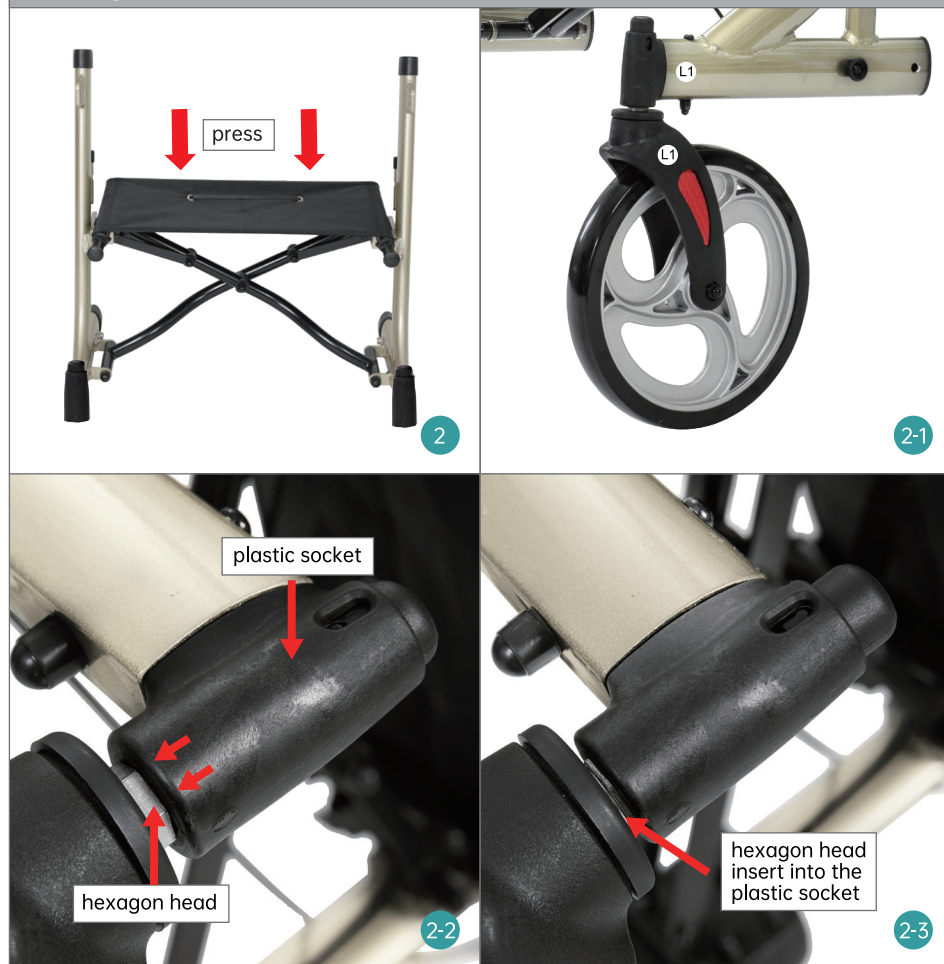

Rear Wheel Assembly

Remove the plug before installing (fig 2-5, 2-6), press spring button of the rear leg (fig 2-7), then insert it into the main frame (fig 2-8), insert the knob to secure the rear leg (fig 2-9), the same steps to assemble the other rear leg (fig 2-10). There are labels "L2-L2, R2-R2" on each leg tube.



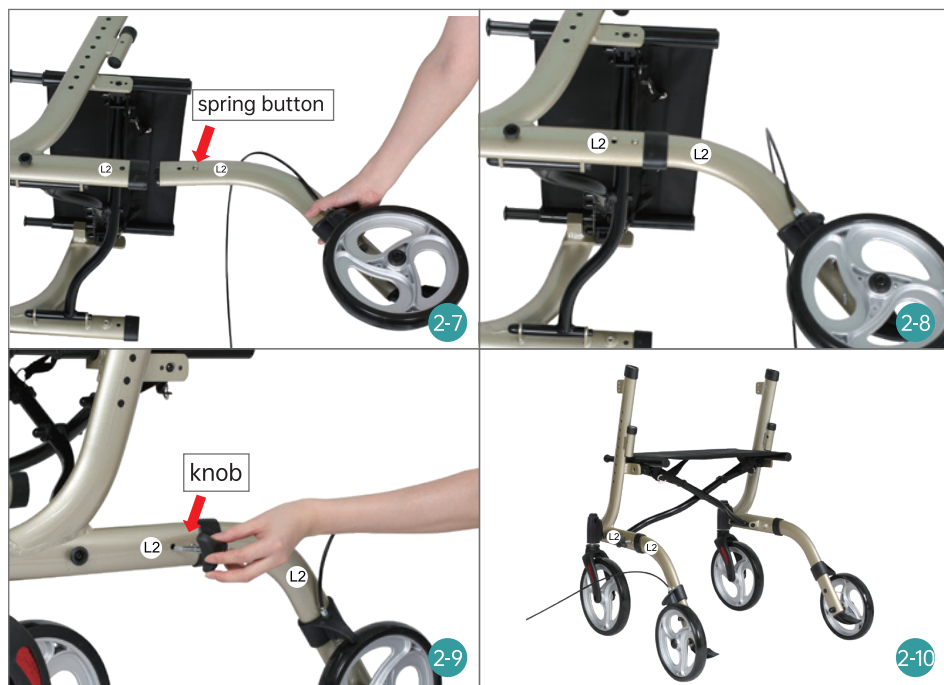

STEP 3

Handle Bar Assembly/The Height of Handle Bar is Adjustable

Insert the handle bar(fig 3), press the height adjustment spring button to achieve desired height(fig 3-1. 3-2). There are labels"L3-L3 R3-R3".

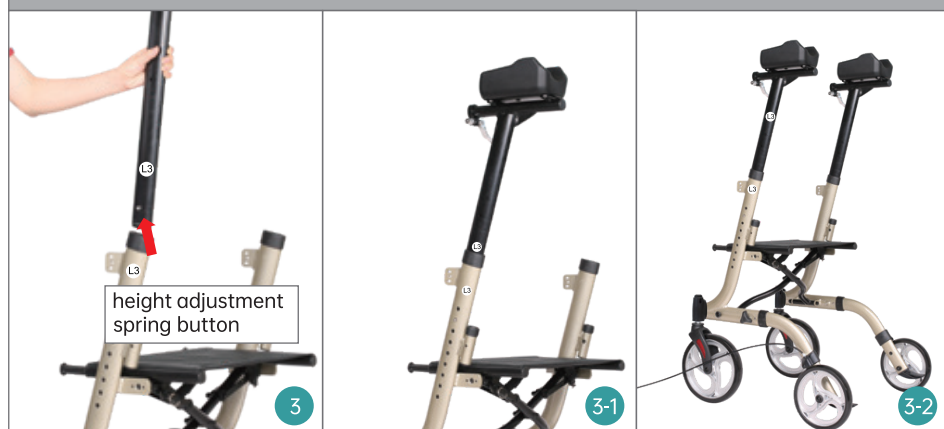

STEP 4

Backrest Assembly

Insert the backrest into the front of the handle bar tube(fig 4), then insert the shorter bolt and nut to secure backrest in place(fig 4-1. 4-2).(nut outside, bolt inside)

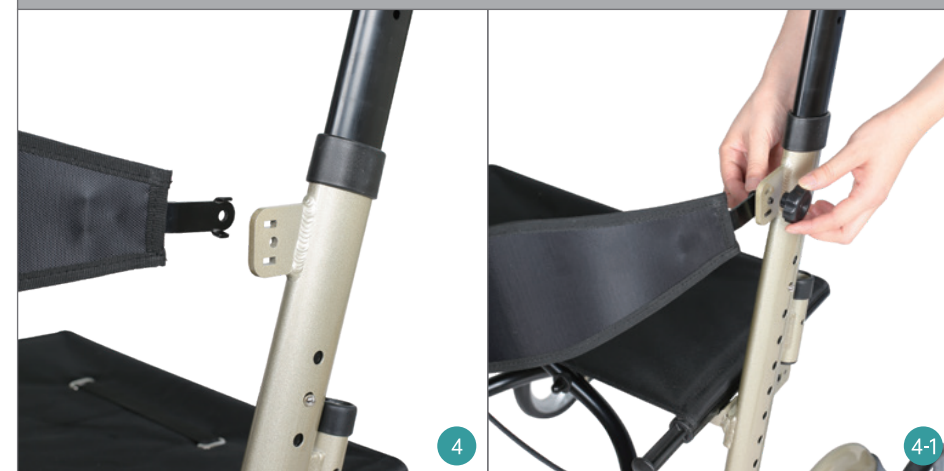

STEP 5

The Handgrip Assembly/The Length and Angle are Adjustable

Insert the handgrip tube into the armrest pad tube(fig 5), adjust the length and the angle to fit your forearm(fig 5-1), then close the handgrip clamp lever (fig 5-2).

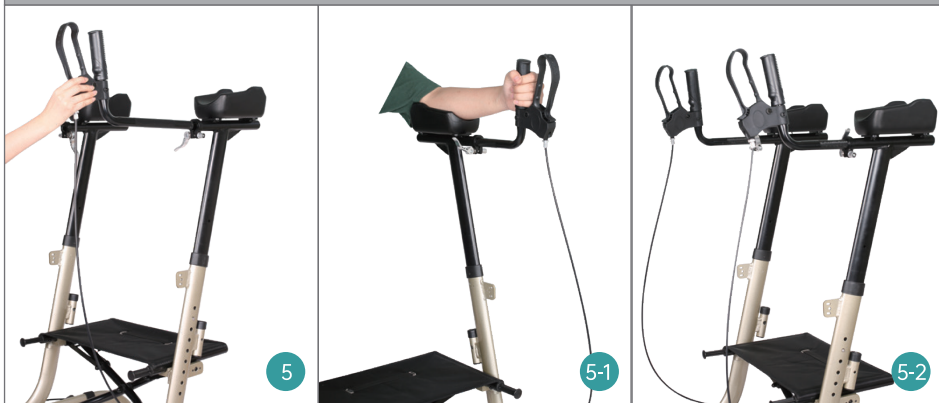

STEP 6

Press spring button and insert it into the handle bar tube(fig 6. 6-1).



STEP 7

Cane/Umbrella Holder Assembly

Insert the holder into slot(fig 7. 7-1).



STEP 8 Storage Bag Assembly

Hang the two hooks of the storage bag on the front of the seat, then tie up the bag with hook & loop(fig 8).



STEP 10 Cup Holder Assembly

Insert cup holder into the groove (fig 10, 10-1).

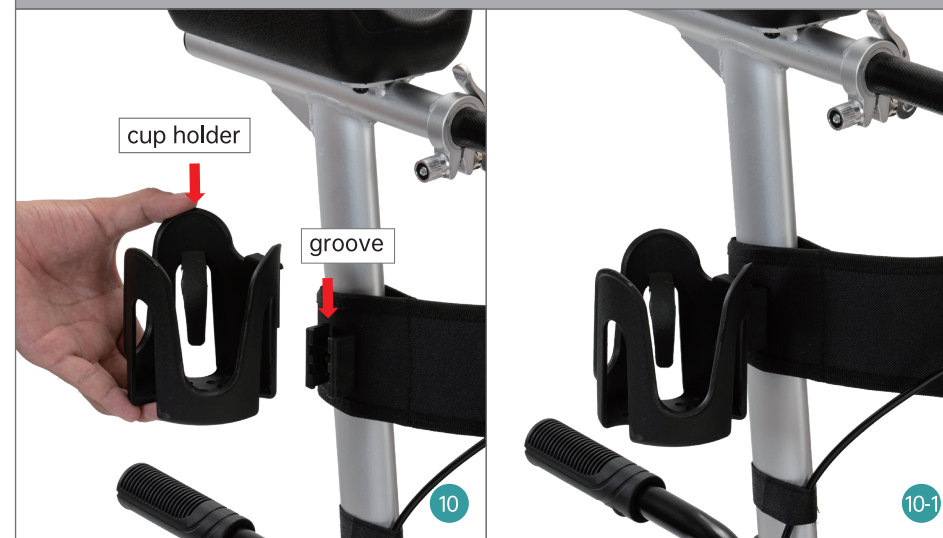

STEP 9 Organize Brake Cables

Attach brake cable on tube with hook and loop.(fig 9)



ONE-HAND FOLDING

Fold the walker by pulling up the strap of seat(fig 11, 11-1).

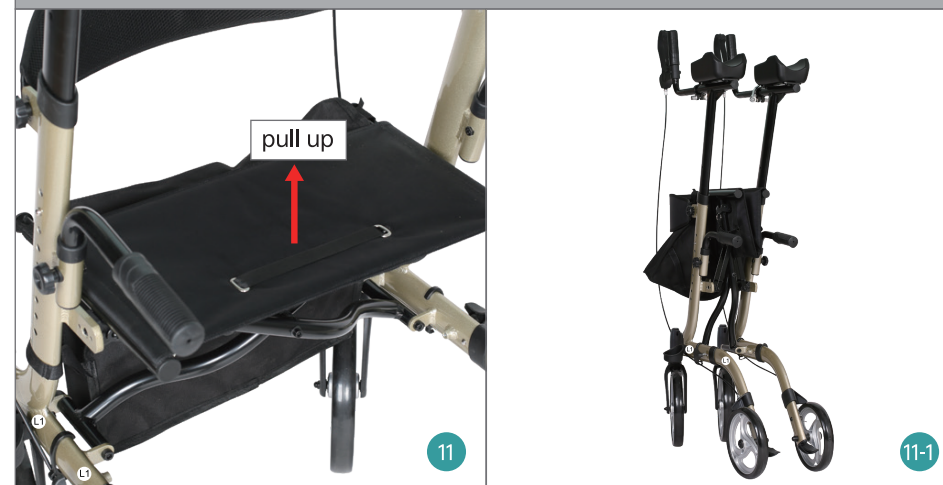

THE CURB CLIMBER

Use it to overcome obstacles such as curbs and thresholds(fig 12).



HAND BRAKE OPERATION

1. Squeeze handbrake to slow the walker(fig 13).
2. Push handbrake to lock the rear wheel(fig 13-1).



HOW TO ADJUST BRAKES

Brake Issue:The brake cannot engage rear wheel when squeezing handbrake (fig A).



Adjust Rear Brake Position

Tools: Plier or 10mm wrench (fig 1).

Use plier(or 10mm wrench) to turn M6 nut counter-clockwise(fig 2-3). And brake will be closer to wheel(fig 4). Then squeeze handbrake, if it doesn't work, repeat the steps until rear brake can engage wheel.

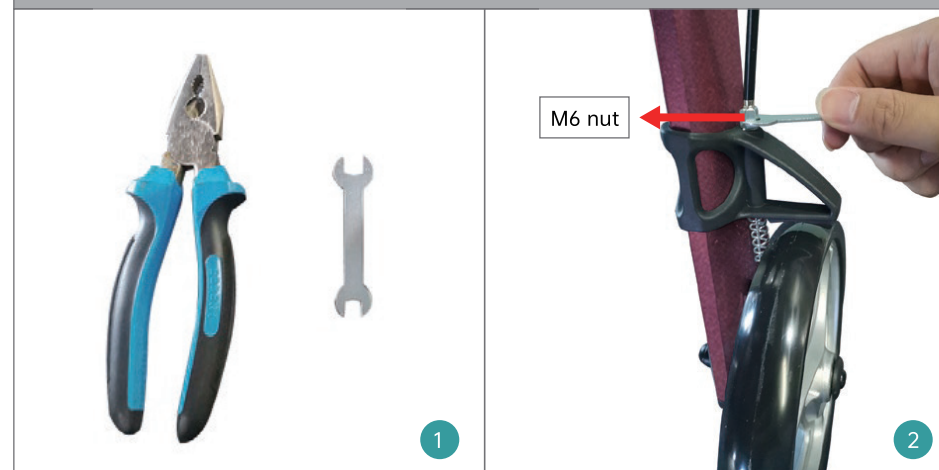

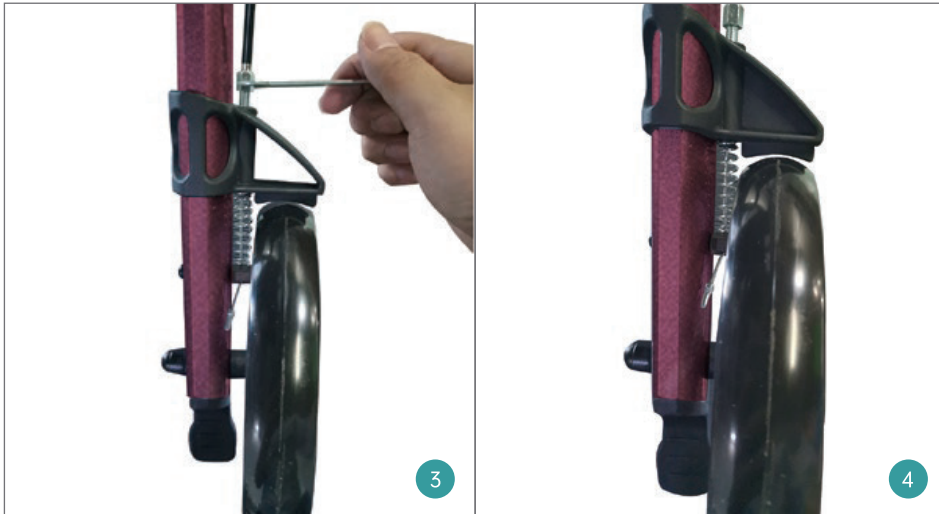

CONTACT US

For any defects, parts missing, use or repair concerning our products, please contact us first, our customer service will reply within 24 hours and offer a good solution. Thank you for your support.





1. E-mail: elenkerservice@hotmail.com
2. Amazon Message: Click the Sold by "store name" under the buy box, than "ask a question". (Amazon Buyer)
3. Customer Help Line: (800) 401-7769

WARRANTY

- * You may return most new, unopened items sold and fulfilled by Amazon within 30 days of delivery for a full refund.
- * Defects in material accessories and non-durable components such as wheels, brakes, seat, handgrips and under NORMAL use for the lifetime warranty of the original consumer purchaser.
- * The warranty does not extend to device failure due to owner misuse or negligence, or normal wear, tear and need periodic replacement.
- * During warranty periods, our warranties cover all parts labor and shipping for repairing this walker.

WARNINGS

To ensure your safety in using ELENKER Rollator Walker, all the following instructions must be followed

-  The maximum load of the walker is 300lbs.
-  DO NOT use walker, if there is apparent damage or if any parts are missing.
-  Ensure that brakes, height adjustment bolts or any other moving parts are in good condition and check all screws and fasteners, and retighten if necessary.
-  DO NOT use on stairs, escalators, moving sidewalks, or go up or down inclines greater than 15% or diagonally across inclines greater than 5%.
-  Be careful to avoid pinching your fingers while raising and lowering the handle bar and opening and closing the rollator walker frame.