

B BEYOUR WALKER

BEYOU

RWAL



KER

ROLLATOR
WALKER

ROLLATOR
WALKER



INSTALLATION



USER MANUAL

Parts:



1 Padded Backrest

2 Padded Seat

3 Front Wheels

4 Handgrips

5 Handbrake

6 Basket

7 Cane Holder

8 Rear Wheels

SET-UP INSTRUCTIONS

STEP 1

Unbox the walker on a level floor.



ACCESSORIES LIST



2x Bolts and
Nuts



1x Cup Holder



1X Cane/Umbrella Holder

STEP 2

Four Wheels Assembly

Take out the main frame(fig 2). Press the spring button of the wheel tube, then insert the front and the rear wheels tube into the bottom tube of the main frame(fig 2-1. 2-2. 2-3. 2-4. 2-5). Pay attention to the installed position of the front and rear wheel(fig 2-6). There are labels on each tube"L1-L1, L2-L2, R1-R1, R2-R2"

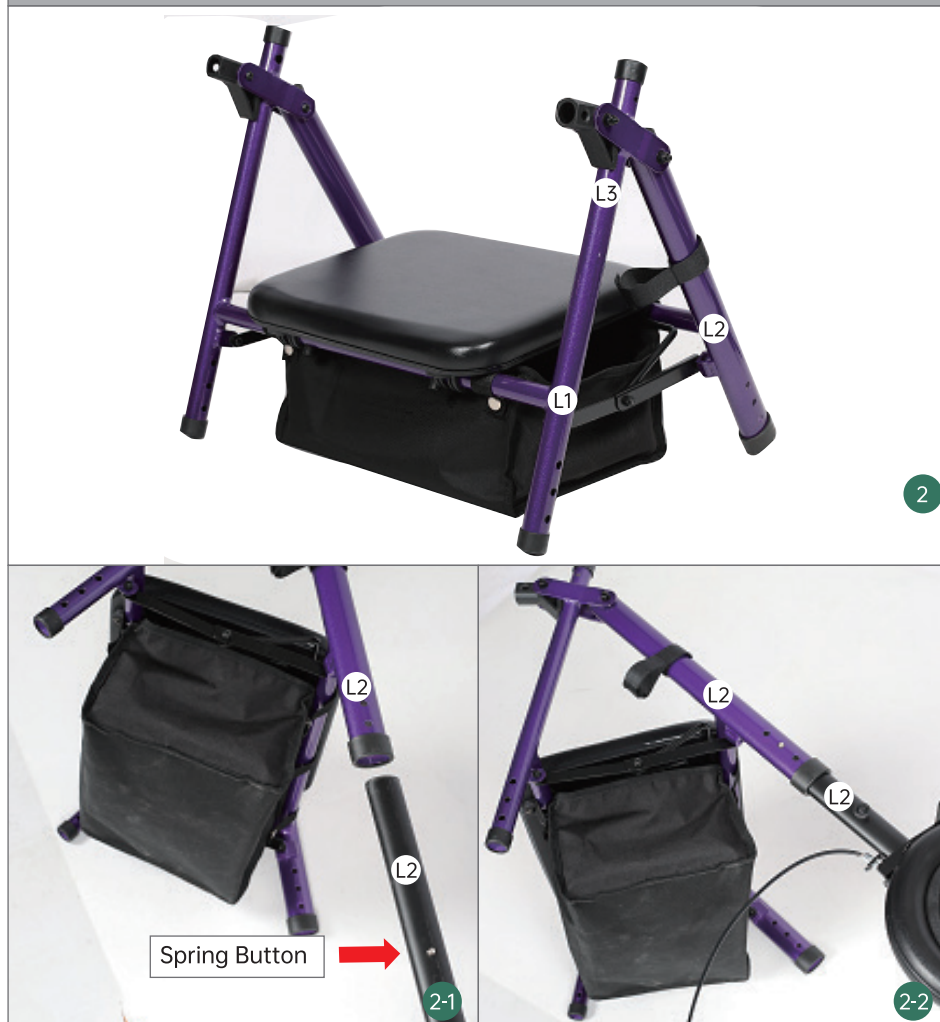

STEP 3

Handle Bar Assembly

Insert the handle bar, raise or lower the handle bar to the desired height(fig 3). Then install the bolt and nut to secure the handle bar in place(fig 3-1. 3-2 3-3). There are labels "L3-L3, R3-R3" on each tube.

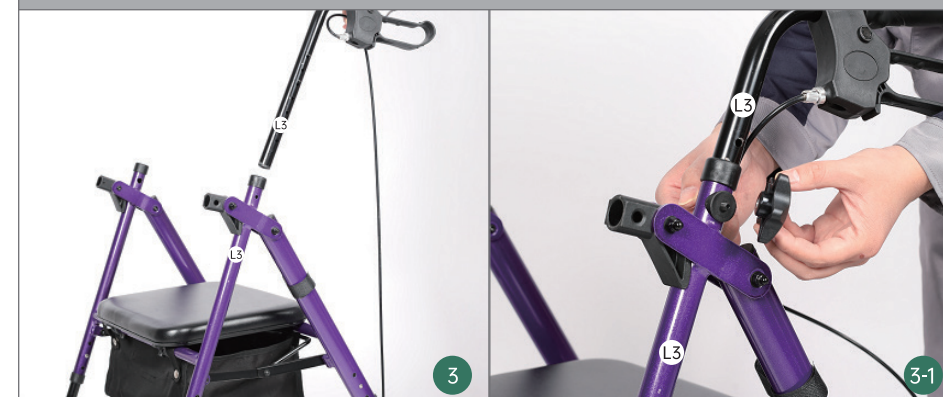



STEP 4 Backrest Assembly

Insert backrest into the main frame(fig 4. 4-1).



STEP 5 Cane/Umbrella Holder Assembly

The left tube of rear wheel has a slot, insert the holder into the slot(fig 5. 5-1).

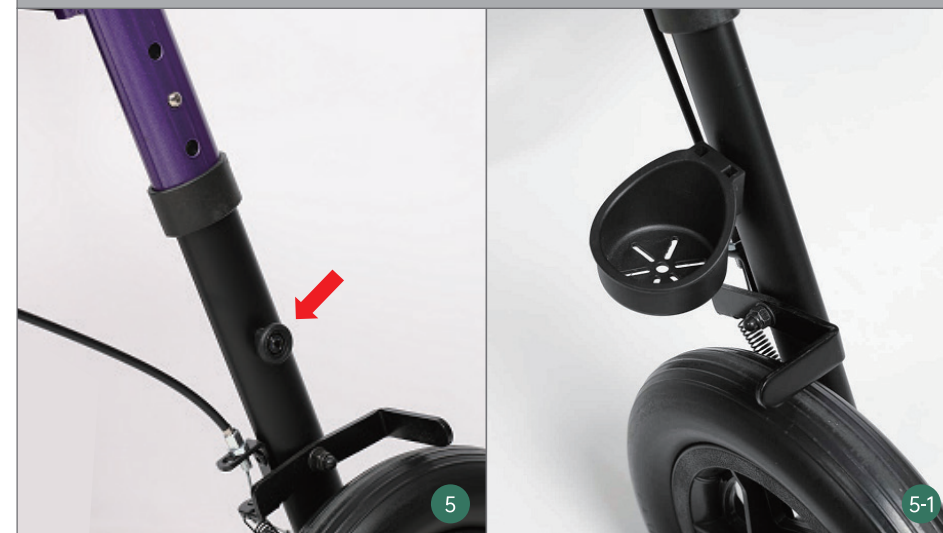

STEP 6 Brake Cable Hook & Loop Strip Assembly

Attach brake cable and Hook & Loop Strip on leg tube(fig 6).



STEP 7

Cup Holder Assembly

Affix cup holder on right handle bar(fig 7).



HANDBRAKES OPERATION

1. Squeeze to slow
2. Push down to lock the rear wheels



THE CURB CLIMBER

Use it to overcome obstacles such as curbs and thresholds(fig 8 8-1).



ONE-HAND FOLDING

Pull up the bracket to fold the walker.

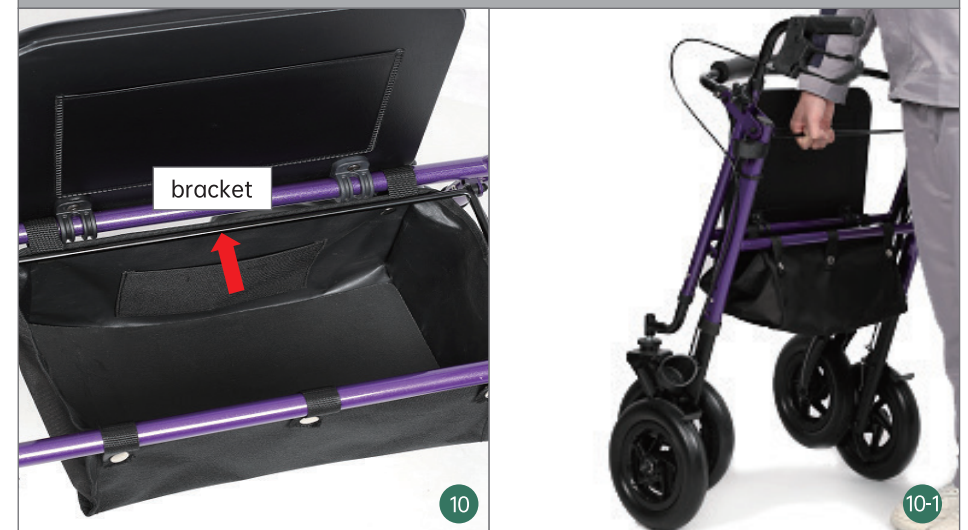

HOW TO ADJUST BRAKES

Brake Issue: The brake cannot engage rear wheel when squeezing handbrake (fig A).



Adjust Rear Brake Position

Tools : Plier and 10mm wrench(or 2x 8mm+10mm wrenches)(fig 1).
Use 10mm wrench to hold M6 nut, then use 8mm wrench or plier to turn M5 nut clockwise(fig 2-4). And brake will be closer to wheel(fig 5). Then squeeze handbrake, if it doesn't work, repeat the steps until rear brake can engage wheel.

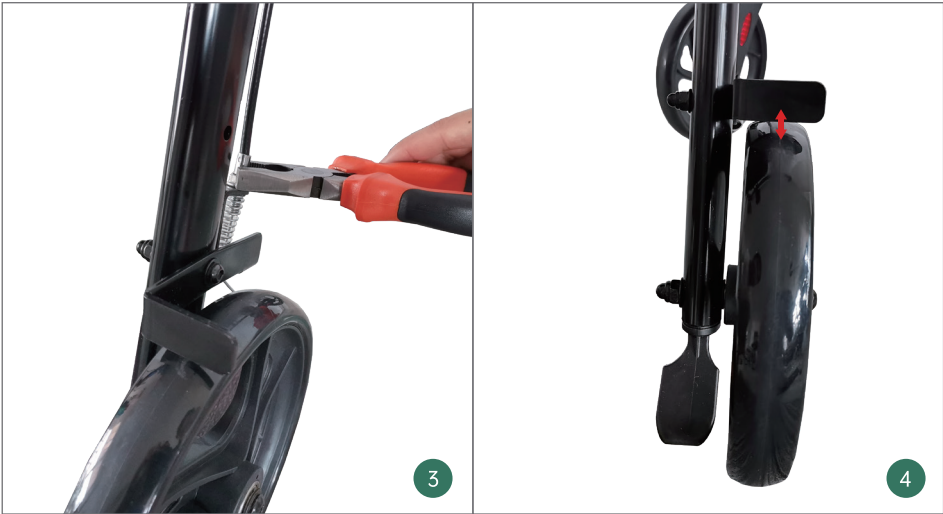

Assembly video on YouTube, please search "How to Set-up HFK-9236D Rollator Walker" Or scan the QR code of installation. (on title page)

CONTACT US

For any defects, parts missing, use or repair concerning our products, please contact us first, our customer service will reply within 24 hours and offer a good solution. Thank you for your support.

1. E-mail: service@cobblehome.com
2. Amazon Message: Click the Sold by "store name" under the buy box, than "ask a question". (Amazon Buyer)
3. Customer Help Line: 800-513-5727
4. Victor, 1885 Vineyard Avenue Building 16 Unit 3
Ontario, CA 91761 United States.

WARRANTY

- * You may return most new, unopened items sold and fulfilled by Amazon within **30** days of delivery for a full refund.
- * Defects in material accessories and non-durable components such as wheels, brakes, seat, handgrips and under NORMAL use for the **lifetime** warranty of the original consumer purchaser.
- * The warranty does not extend to device failure due to owner misuse or negligence, or normal wear, tear and need periodic replacement.
- * During warranty periods, our warranties cover all parts labor and shipping for repairing this walker.

WARNINGS

To ensure your safety in using BEYOUR WALKER Rollator Walker, all the following instructions must be followed

 The maximum load of the walker is 300lbs.

 DO NOT use walker, if there is apparent damage or if any parts are missing.

 Ensure that brakes, height adjustment bolts or any other moving parts are in good condition and check all screws and fasteners, and retighten if necessary.

 DO NOT use on stairs, escalators, moving sidewalks, or go up or down inclines greater than 15% or diagonally across inclines greater than 5%.

 Be careful to avoid pinching your fingers while raising and lowering the handle bar and opening and closing the rollator walker frame.