



E L E

N K

E R

HFK-9240
ROLLATOR
WALKER

HFK-9240
ROLLATOR
WALKER



USER MANUAL

Parts:



- | | |
|------------------------|-----------------------------|
| 1 Handbrake | 8 Handgrip |
| 2 Handgrip Clamp Lever | 9 Armrest Pad |
| 3 Cup Holder | 10 Height Adjustment Button |
| 4 Backrest | 11 Sit-to-stand Handle Bar |
| 5 Seat | 12 Cane Holder |
| 6 Storage Bag | 13 Rear Wheel |
| 7 Front Wheel | |

SET-UP INSTRUCTIONS

STEP 1

Unbox the walker on a level floor.

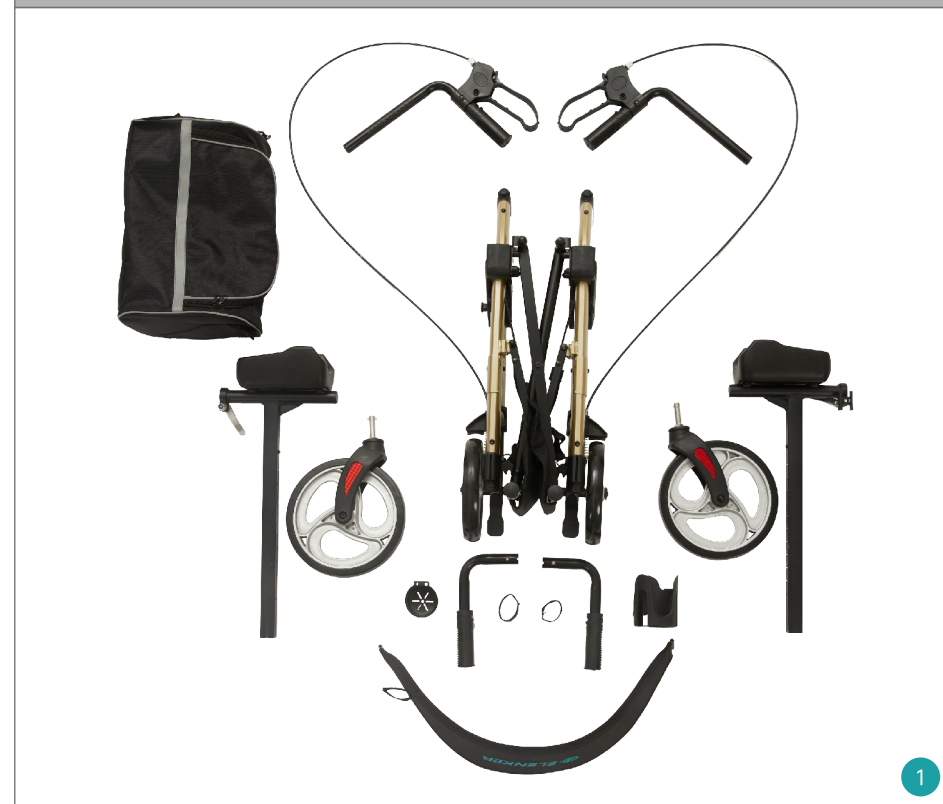

ACCESSORIES LIST



1x Cane Holder

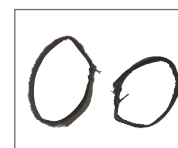

2x Hook and Loop Straps



2x Sit-to-stand Handle Bars



1x Cup Holder

STEP 2

Open The Main Frame

Take out the main frame, put the seat part up(fig2, fig 2-1), then open the seat and press it to be locked(fig 2-2).

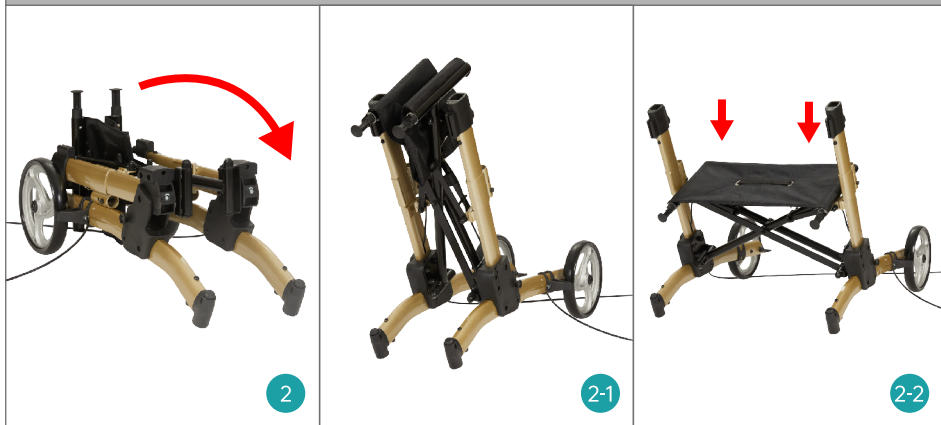

STEP 3

The Front Wheels Assembly

Insert the wheel into the main frame(fig 3, 3-1), make sure the hexagon head insert into the plastic socket(fig 3-2, 3-3), the same steps to assemble the other front wheel(fig 3-4).

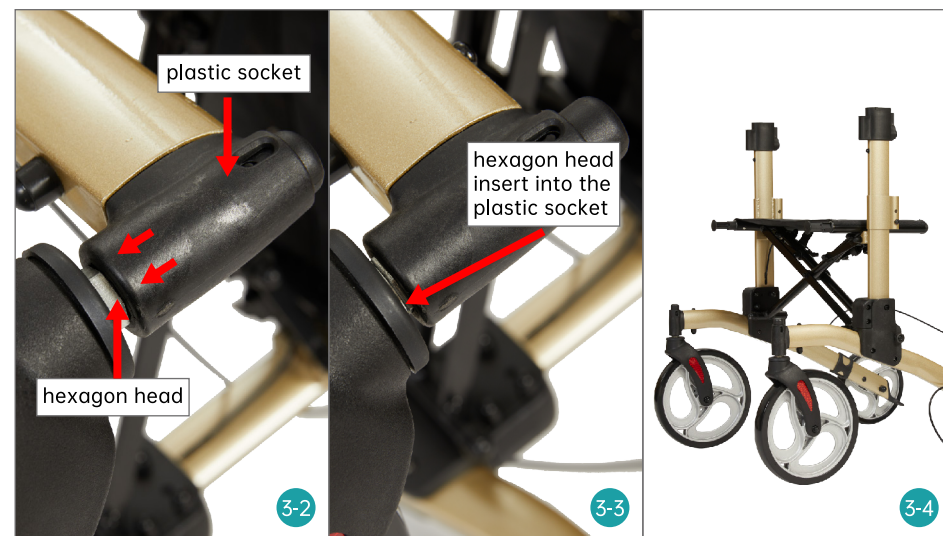
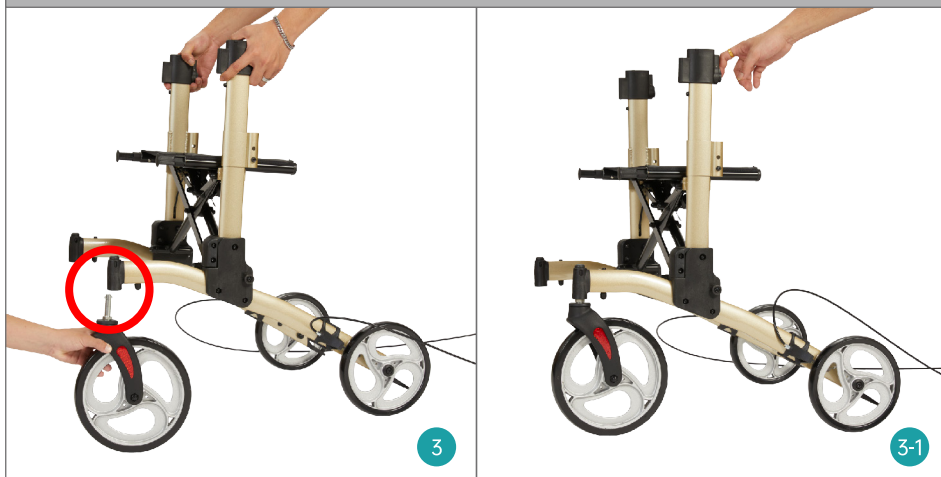

STEP 4

Handle Bars Assembly

Insert the handle bar into the main frame, press the height adjustment button to set your desired height(fig 4. 4-1. 4-2).

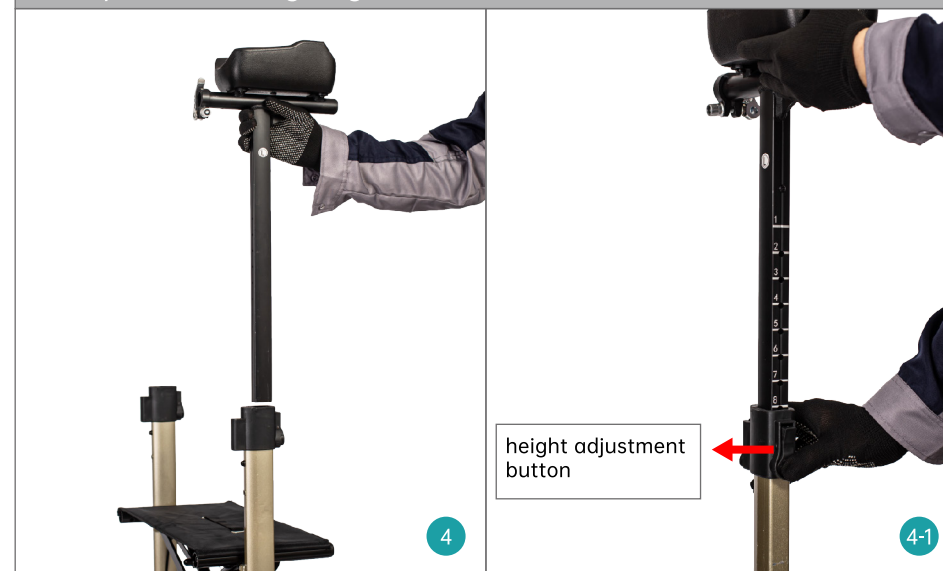



STEP 5 Handgrips Assembly

Insert the handgrip tube into the armrest pad tube(fig 5), adjust the length and the angle to fit your forearm(fig 5-1. 5-2), then close the handgrip clamp lever (fig 5-3).

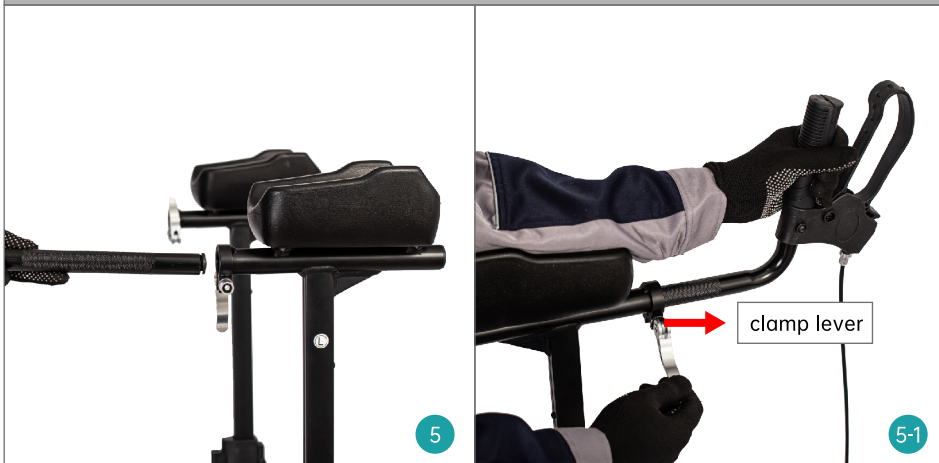

STEP 6 Backrest Assembly

Insert the backrest into the slot of handle bar(fig 6. 6-1).

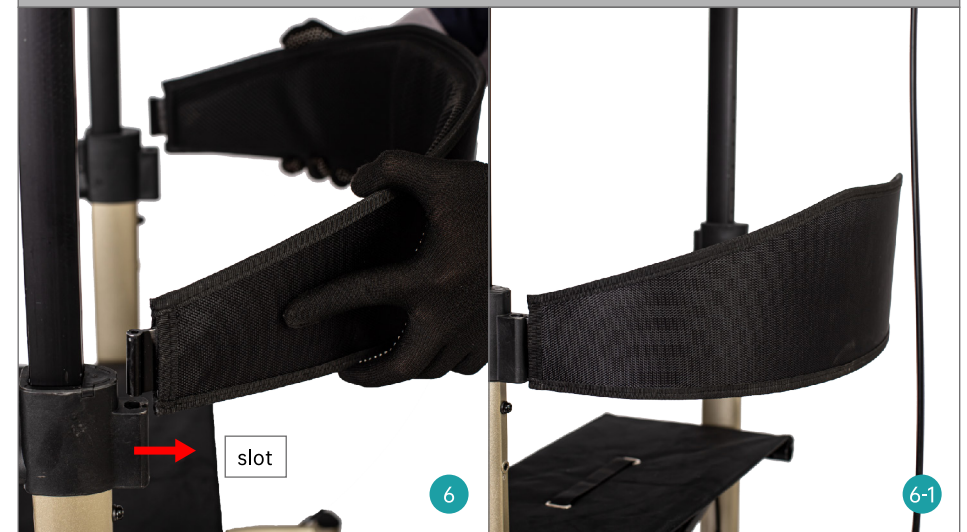

STEP 7

Storage Bag Assembly

Pull out the seat stick, then hang the storage bag on it (7, 7-1).



STEP 8

Sit-to-stand Handle Bars Assembly

Press the spring button, then insert it into the main frame (fig 8, 8-1), the same steps to assemble the other handle (fig 8-2).

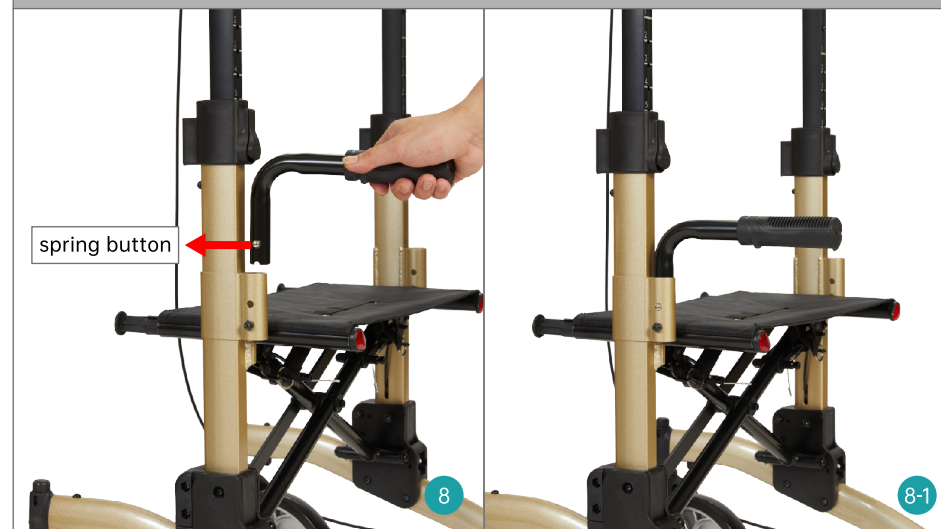

STEP 9 Organize Brake Cables

Attach brake cable on tube with hook and loop strap.(fig 9)



STEP 10 Cane/Umbrella Holder Assembly

Insert the holder into the knob(fig 10, 10-1).(The knob is on the left leg tube)

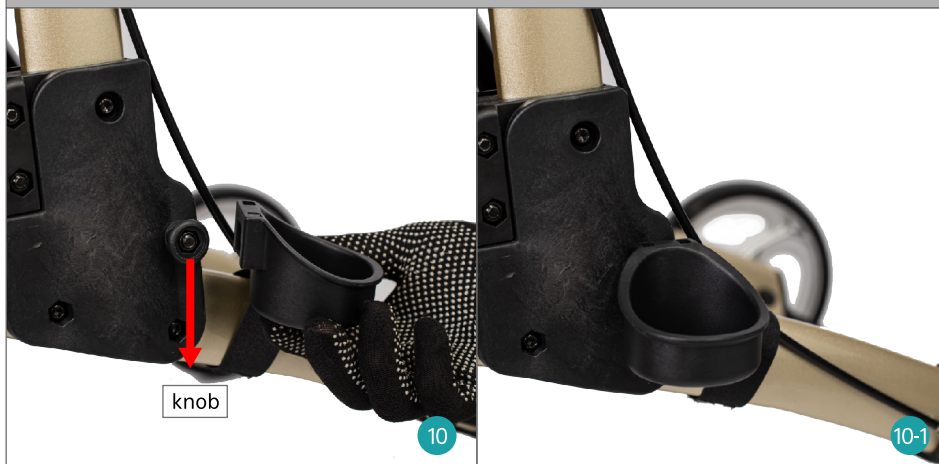

STEP 11 Cup Holder Assembly

Insert the cup holder into the groove(fig 11, 11-1).



ONE-HAND FOLDING

Fold the walker by pulling up the strap of seat(fig 12. 12-1). Then push the upper part backward(fig 12-2), the walker will be folded flat easily.

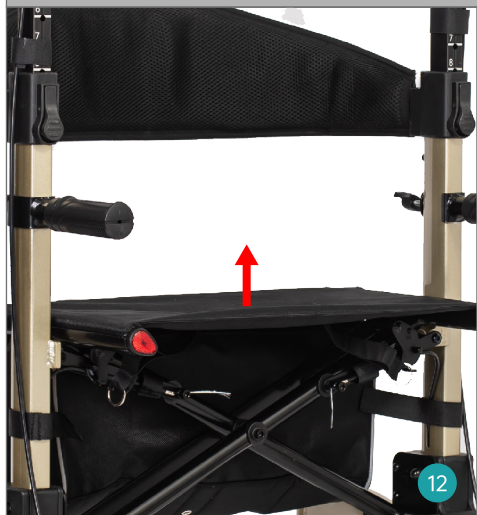

12



Side-to-side Folding

12-1



Flat Folding

12-2

THE FOOT LIFT

It assists user to go up curb or threshold easily, prevent from tipping over (fig 13).



13

HAND BRAKE OPERATION

- 1.Squeeze handbrake to slow the walker(fig 14).
- 2.Push handbrake to lock the rear wheel(fig 14-1).

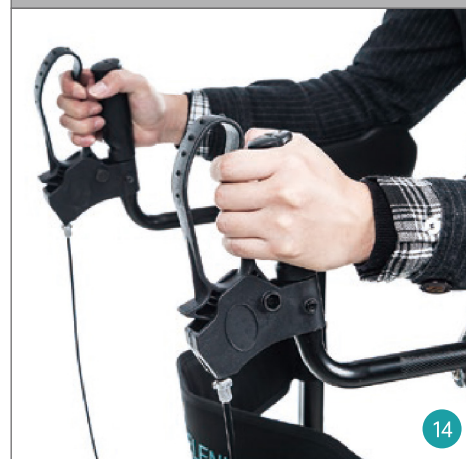

14



14-1

HOW TO ADJUST BRAKES

Brake Issue: The brake cannot engage rear wheel when squeezing handbrake (fig A).



Adjust Rear Brake Position

Tools: Plier or 10mm wrench (fig 1).
Use plier(or 10mm wrench) to turn M6 nut counter-clockwise(fig 2-3). And brake will be closer to wheel(fig 4). Then squeeze handbrake, if it doesn't work, repeat the steps until rear brake can engage wheel.

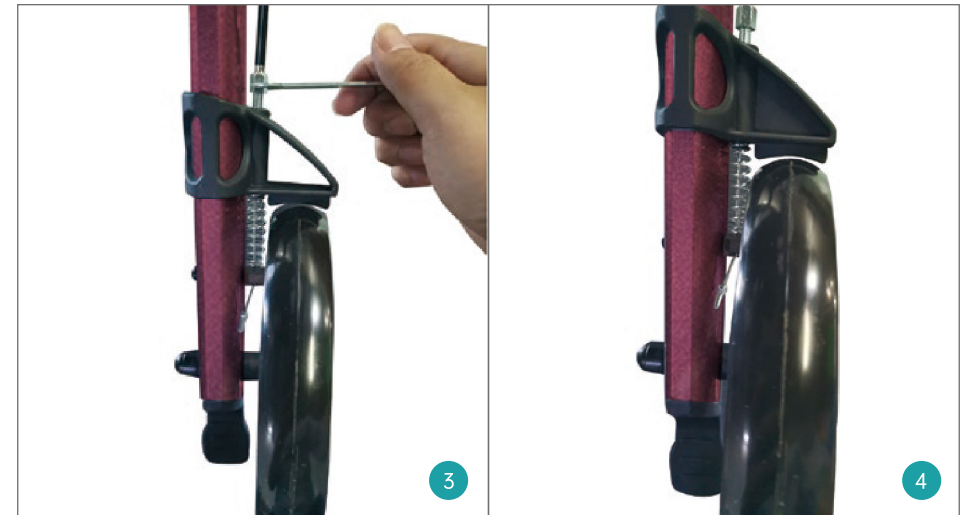
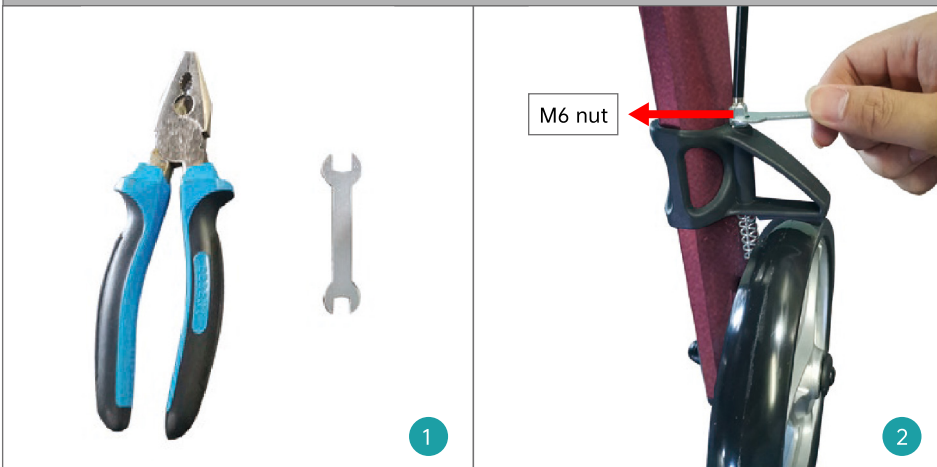

CONTACT US

For any defects, parts missing, use or repair concerning our products, please contact us first, our customer service will reply within 24 hours and offer a good solution. Thank you for your support.

1. E-mail: elenkerservice@hotmail.com
2. Amazon Message: Click the Sold by "store name" under the buy box, than "ask a question". (Amazon Buyer)
3. Customer Help Line: (800)401-7769

WARRANTY

- * You may return most new, unopened items sold and fulfilled by Amazon within **30** days of delivery for a full refund.
- * Defects in material accessories and non-durable components such as wheels, brakes, seat, handgrips and under NORMAL use for the **lifetime** warranty of the original consumer purchaser.
- * The warranty does not extend to device failure due to owner misuse or negligence, or normal wear, tear and need periodic replacement.
- * During warranty periods, our warranties cover all parts labor and shipping for repairing this walker.

WARNINGS

To ensure your safety in using ELENKER Rollator Walker, all the following instructions must be followed

 The maximum load of the walker is 300lbs.

 DO NOT use walker, if there is apparent damage or if any parts are missing.

 Ensure that brakes, height adjustment bolts or any other moving parts are in good condition and check all screws and fasteners, and retighten if necessary.

 DO NOT use on stairs, escalators, moving sidewalks, or go up or down inclines greater than 15% or diagonally across inclines greater than 5%.

 Be careful to avoid pinching your fingers while raising and lowering the handle bar and opening and closing the rollator walker frame.