



E L E

N K

E R

HFK-9240B-1
ROLLATOR
WALKER

HFK-9240B-1
ROLLATOR
WALKER



USER MANUAL

Parts:



- | | |
|------------------------|-----------------------------|
| 1 Handbrake | 8 Handgrip |
| 2 Handgrip Clamp Lever | 9 Armrest Pad |
| 3 Cup Holder | 10 Height Adjustment Button |
| 4 Backrest | 11 Sit-to-stand Handle Bar |
| 5 Seat | 12 Release button |
| 6 Storage Bag | 13 Cane Holder |
| 7 Front Wheel | 14 Rear Wheel |

SET-UP INSTRUCTIONS

STEP 1

Unbox the walker on a level floor.



ACCESSORIES LIST



1x Cane Holder

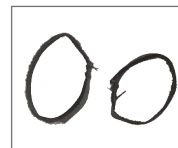

2x Hook and Loop Straps



2x Sit-to-stand Handle Bars



1x Cup Holder

STEP 2

Front Wheels Assembly / Remove Front Wheels

Insert front wheel into the main frame directly(fig 2,2-1)(no need to distinguish the sides of the wheel), repeat the same steps on the other side(fig 2-2,2-3). Press the release button, then pull out wheel.

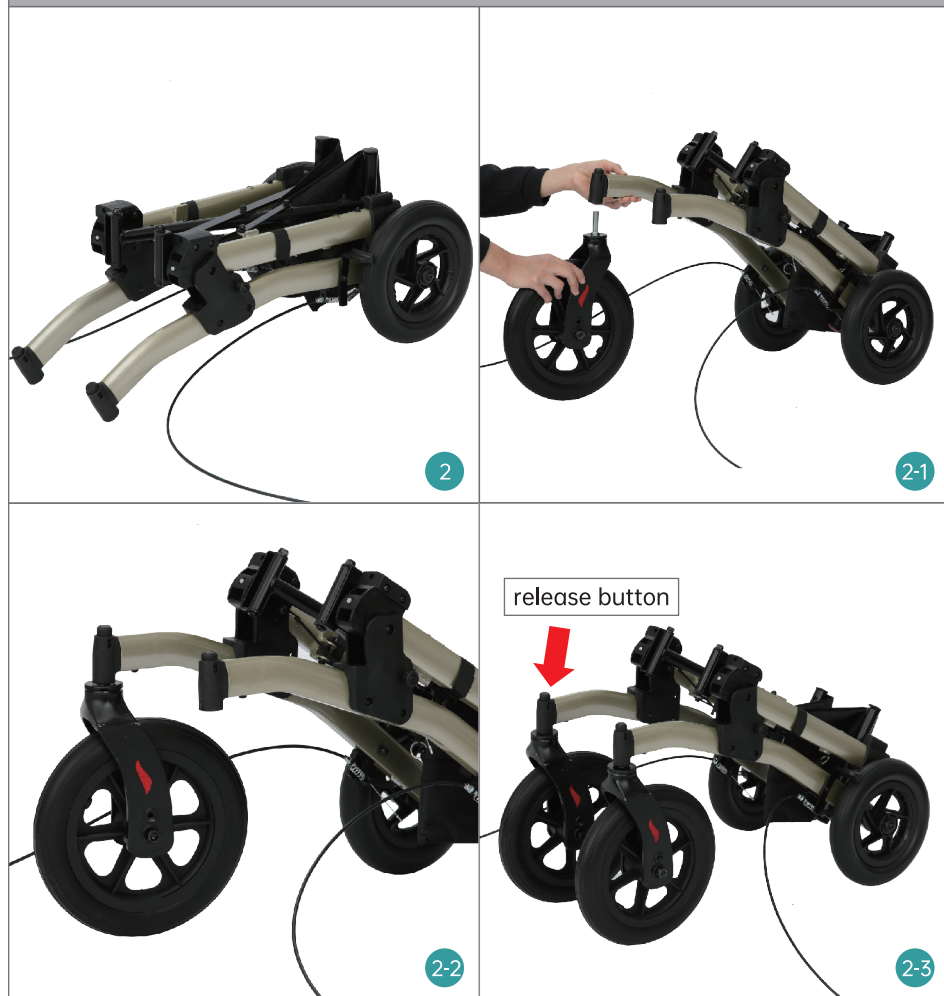

STEP 3

Unfold the Main Frame

Put handle bars up(fig 3,3-1), then press the seat down to be locked(fig 3-2).

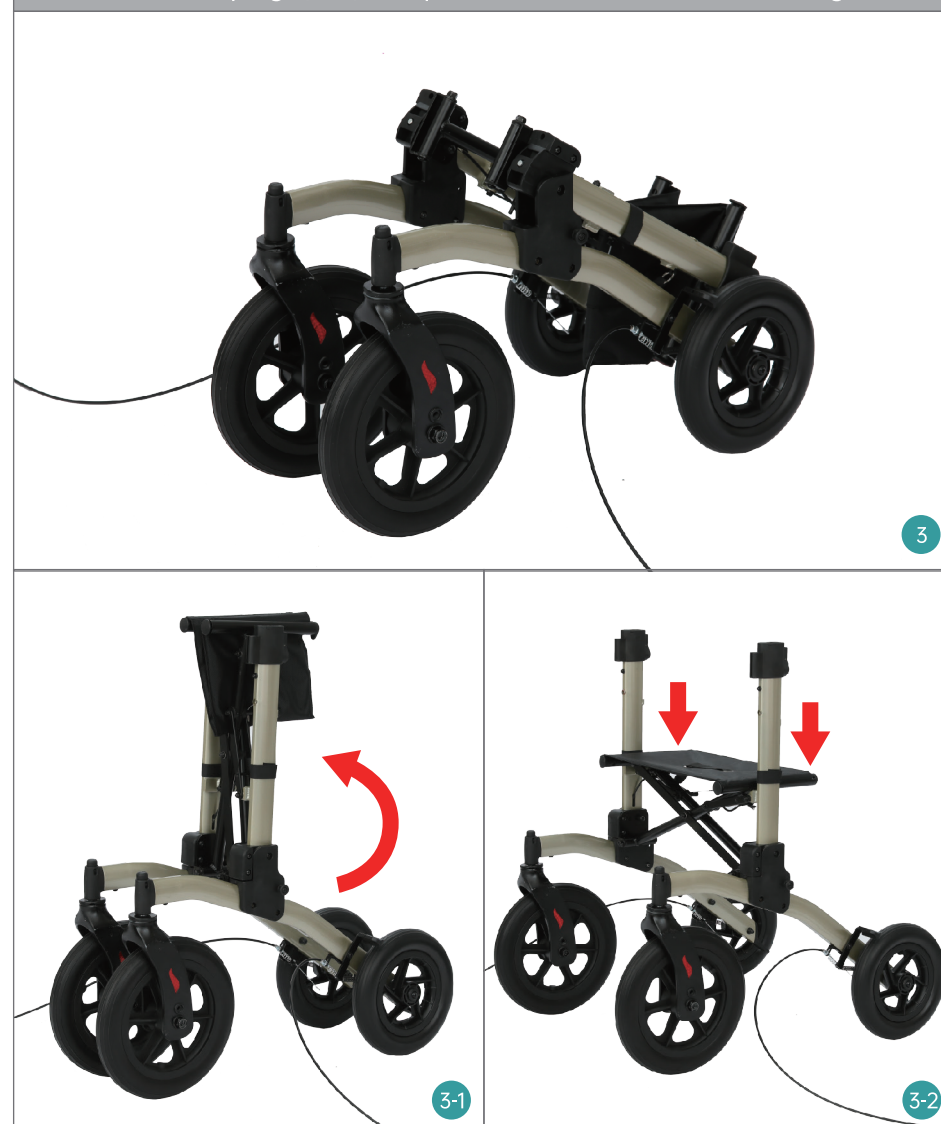

STEP 4

Handle Bars Assembly

Press height adjustment button, then insert handle bar into the main frame and set the desired height(fig 4,4-1), repeat the same steps on the other side (fig 4-2)(There are labels on each tube "L1-L1, R1-R1).

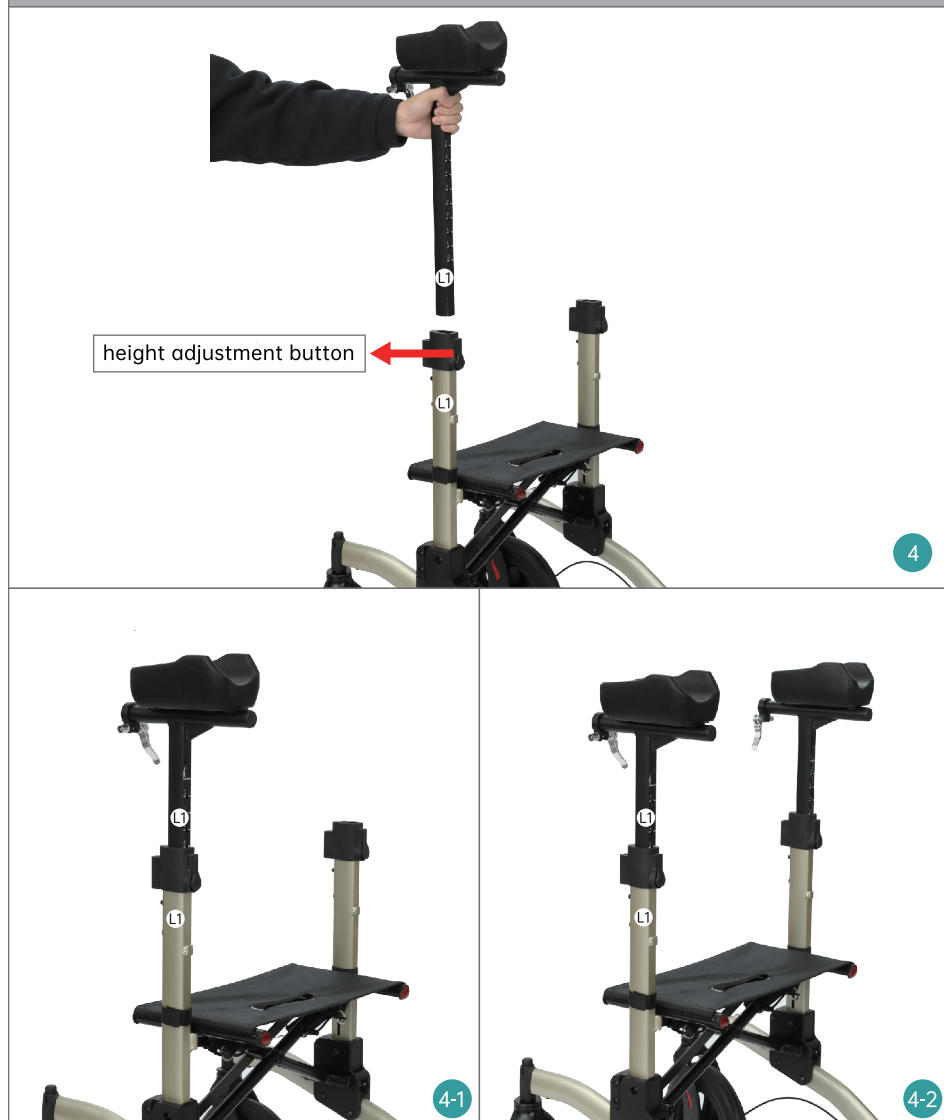

STEP 5

The Handgrip Assembly

Insert the handgrip tube into armrest pad tube(fig 5), adjust length and angle to fit your forearm, then secure the handgrip by closing clamp lever (fig 5-1, 5-2).

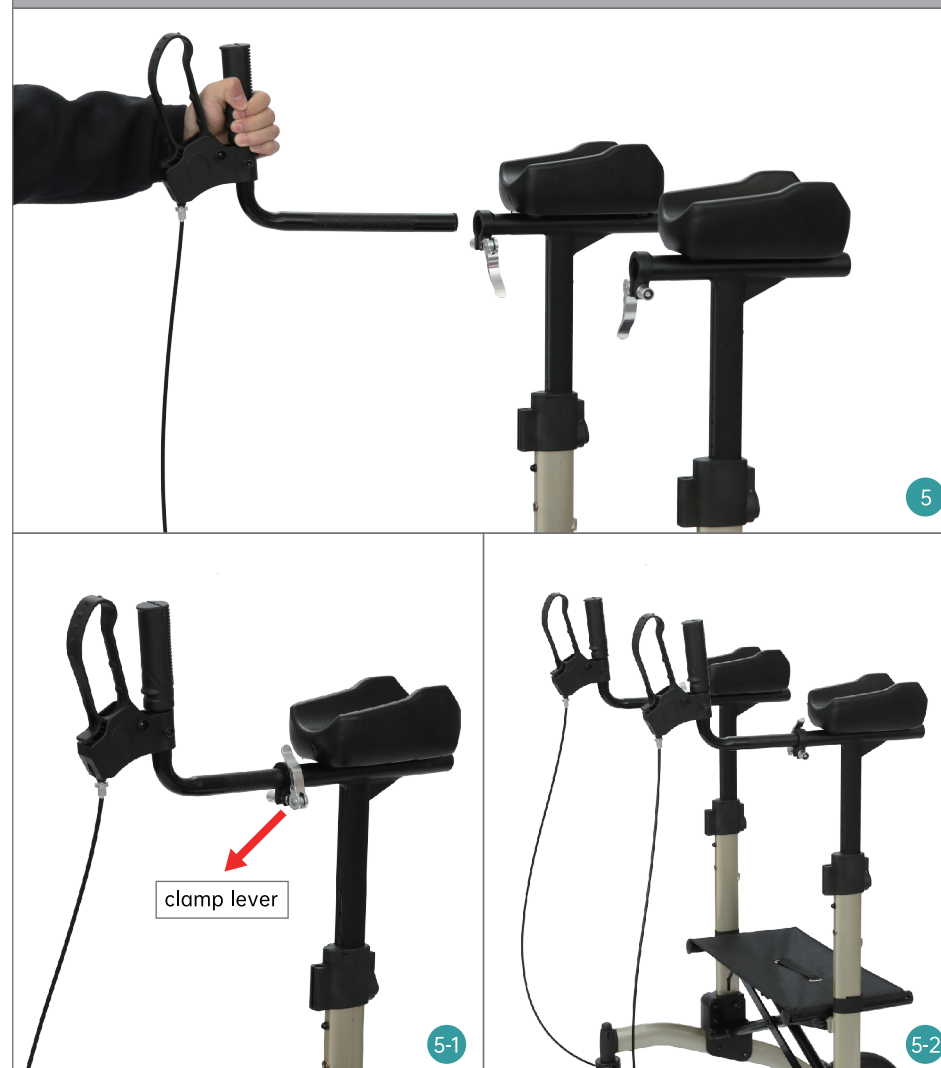

STEP 6 Backrest Assembly

Insert tongue of backrest into groove(fig 6,6-1).

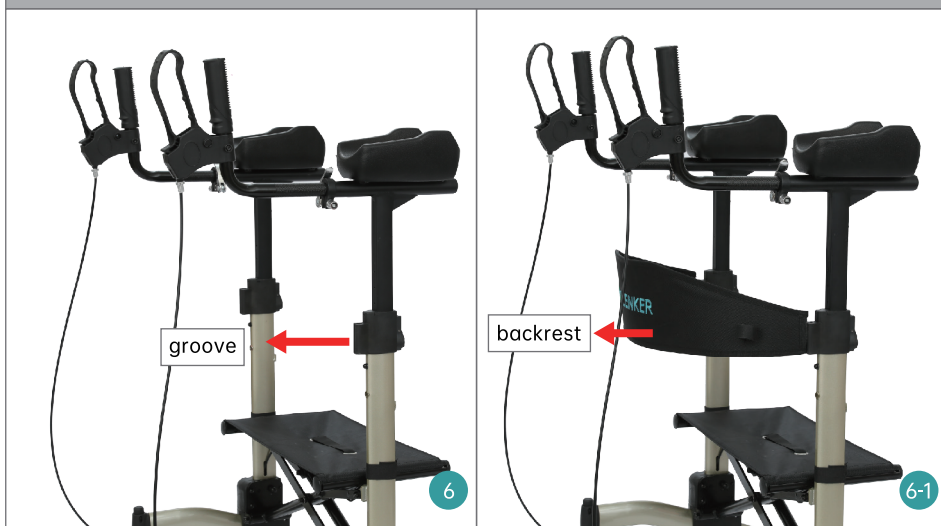

STEP 7 Sit-to-stand Handle Bar Assembly

Press the spring button, then insert it into the main frame(fig 7, 7-1), the same steps to assemble the other handle(fig 7-2).

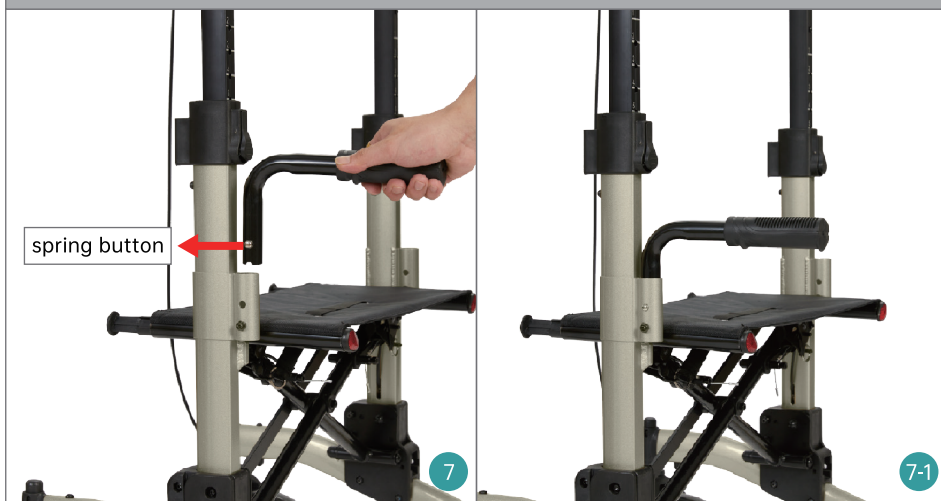

STEP 8 Storage Bag Assembly

Pull sticks of seat out(fig 8,8-1,8-2), then hang storage bag up(fig 8-3).

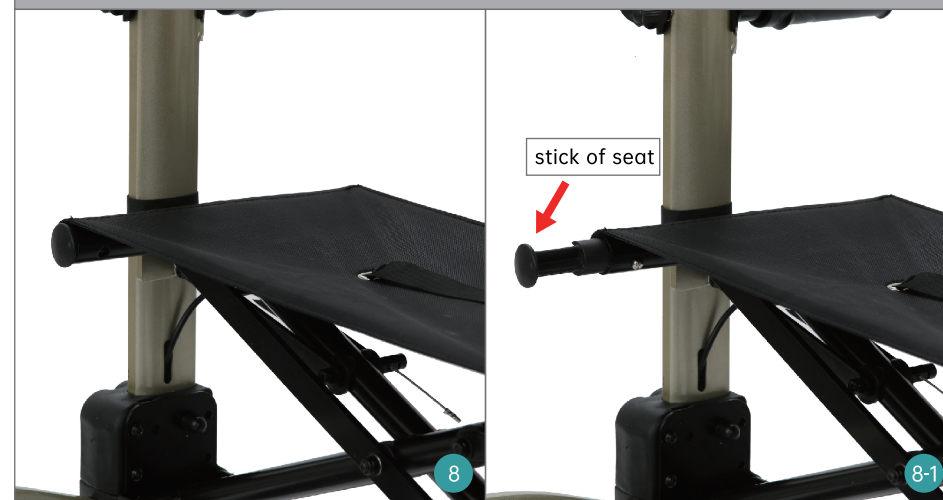



STEP 9 Cane Holder Assembly

Insert cane holder into knob(fig 9,9-1).

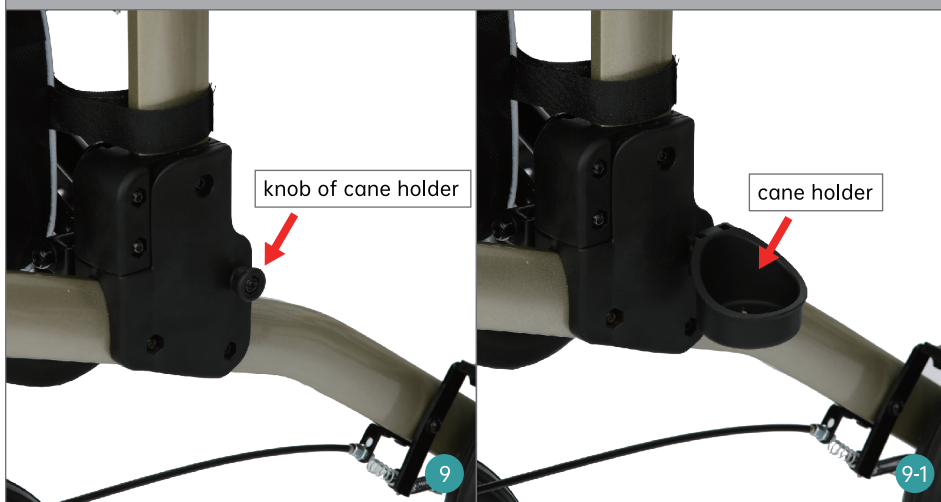

STEP 10 Organize Brake Cables

Attach brake cable on tube with hook and loop strap.(fig 10)

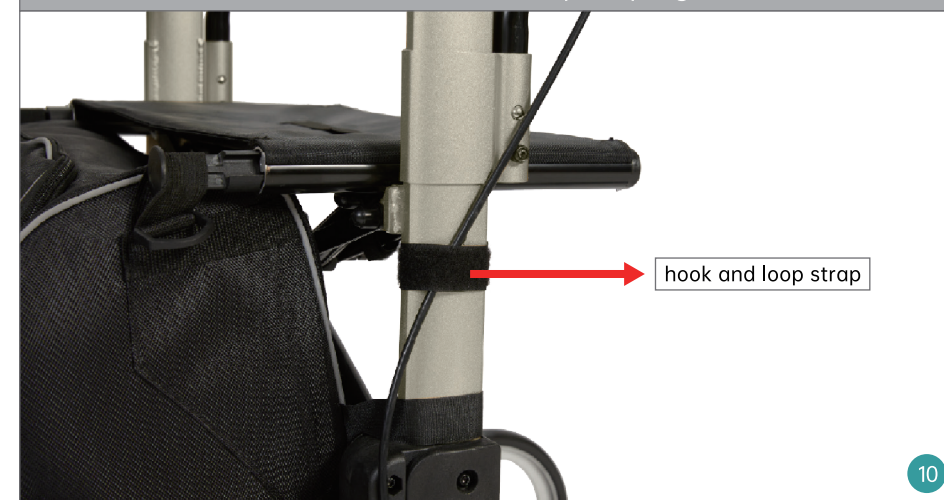

STEP 11 Cup Holder Assembly

Affix cup holder on right handle bar(fig 11. 11-1).

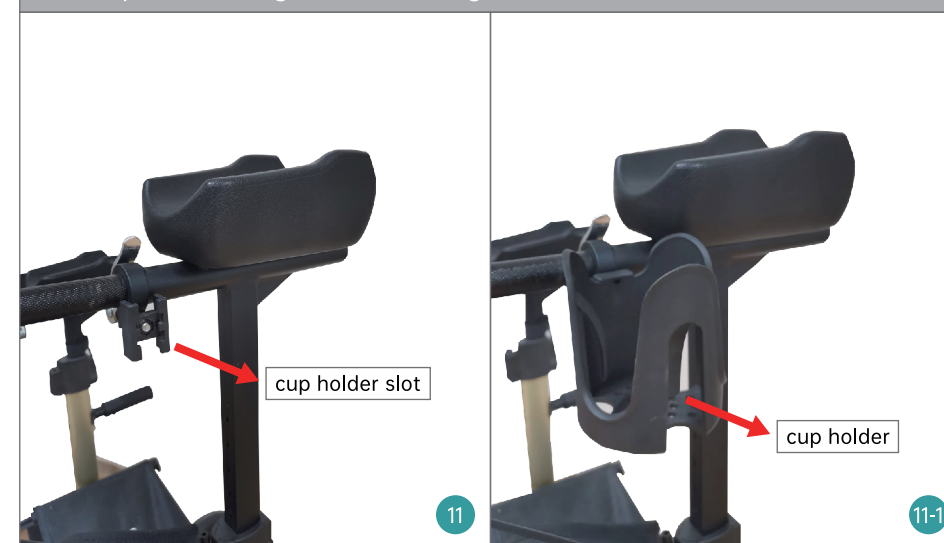

ONE-HAND FOLDING

Fold the walker by pulling up the strap of seat(fig 12, 12-1, 12-2), then put handle bars down, the walker will be folded flat(fig 12-3).



THE CURB CLIMBER

Use it to overcome obstacles such as curbs and thresholds.



HAND BRAKE OPERATION

1. Squeeze handbrake to slow the walker.
2. Push handbrake to lock the rear wheel.

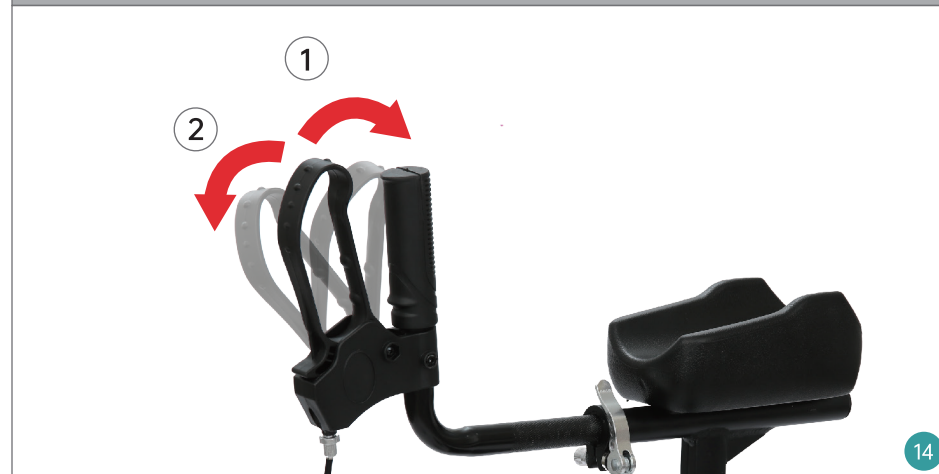

HOW TO ADJUST BRAKES

Brake Issue: The brake cannot engage rear wheel when squeezing handbrake (fig A).



A

Adjust Rear Brake Position

Tools: Plier or 10mm wrench (fig 1).
Use plier(or 10mm wrench) to turn M6 nut counter-clockwise(fig 2-3). And brake will be closer to wheel(fig 4). Then squeeze handbrake, if it doesn't work, repeat the steps until rear brake can engage wheel.



1



2

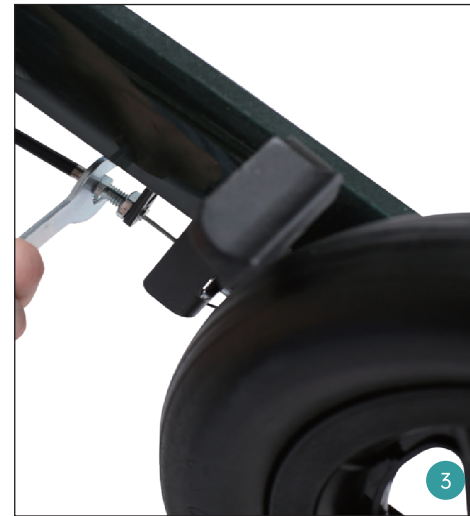

3

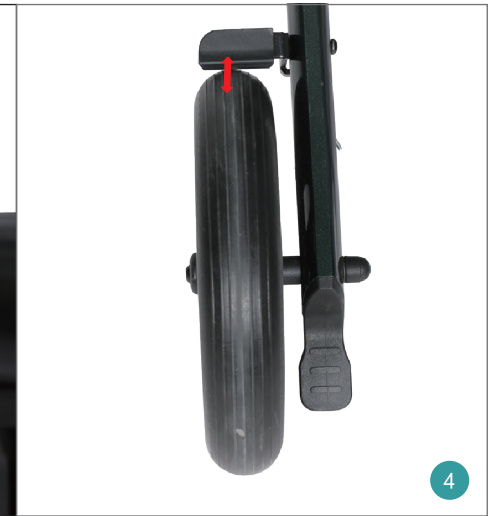

4

CONTACT US

For any defects, parts missing, use or repair concerning our products, please contact us first, our customer service will reply within 24 hours and offer a good solution. Thank you for your support.

1. E-mail: elenkerservice@hotmail.com
2. Amazon Message: Click the Sold by "store name" under the buy box, than "ask a question". (Amazon Buyer)
3. Customer Help Line: (800)401-7769

WARRANTY

- * You may return most new, unopened items sold and fulfilled by Amazon within **30** days of delivery for a full refund.
- * Defects in material accessories and non-durable components such as wheels, brakes, seat, handgrips and under NORMAL use for the **lifetime** warranty of the original consumer purchaser.
- * The warranty does not extend to device failure due to owner misuse or negligence, or normal wear, tear and need periodic replacement.
- * During warranty periods, our warranties cover all parts labor and shipping for repairing this walker.

WARNINGS

To ensure your safety in using ELENKER Rollator Walker, all the following instructions must be followed

 The maximum load of the walker is 300lbs.

 DO NOT use walker, if there is apparent damage or if any parts are missing.

 Ensure that brakes, height adjustment bolts or any other moving parts are in good condition and check all screws and fasteners, and retighten if necessary.

 DO NOT use on stairs, escalators, moving sidewalks, or go up or down inclines greater than 15% or diagonally across inclines greater than 5%.

 Be careful to avoid pinching your fingers while raising and lowering the handle bar and opening and closing the rollator walker frame.