



E L E

N K

E R

HFK-9294-PVC

ROLLATOR
WALKER

HFK-9294-PVC

ROLLATOR
WALKER



USER MANUAL

Parts:



- 1 Cup holder
- 2 Backrest
- 3 Seat
- 4 Storage bag
- 5 Footrest
- 6 Front wheel

- 7 Handgrip
- 8 Handbrake
- 9 Armrest
- 10 Shock absorber
- 11 Rear wheel









SET-UP INSTRUCTIONS

STEP 1

Unbox the walker on a level floor.

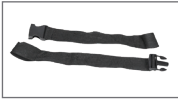

ACCESSORIES LIST

	2x Knobs		x1 "8" Shape hook and loop strap
	2x Wire lock pins		x2 Hook and loop straps
	2x Bolts and nuts		1x Cup holder
	x1 Safety belt		1x Open end wrench

STEP 2

Rear Wheels Assembly

Align the hole of rear leg tube with the bottom hole of main frame (fig 2, 2-1), then insert the bolt and use open end wrench to secure it with nut (fig 2-2). Align the hole of shock absorber with the upper hole of main frame, then secure it with wire lock pin (fig 2-3, 2-4, 2-5, 2-6). The same steps to assemble right rear leg(fig 2-7), there are labels on tubes and main frame "L1-L1, R1-R1".



STEP 3

Handle Bar Tubes Assembly

Insert the safety belt and the handle bar tube into the main frame (fig 3, 3-1), then secure it with knob (fig 3-2, 3-3). The same steps to assemble right handle bar tube(fig 3-4), there are labels on tubes and main frame "L2-L2, R2-R2".



STEP 4

The Footrests Assembly

Insert the footrest pad into the front main frame (fig 4, 4-1), the same steps to assemble right footrest pad (fig 4-2).



STEP 5

Cane Holder Assembly

Insert cane holder into the knob of cane holder(on the left tube) (fig 5, 5-1). Then affix the "8" shape hook and loop strap to secure the upper part of cane (fig 5-2).

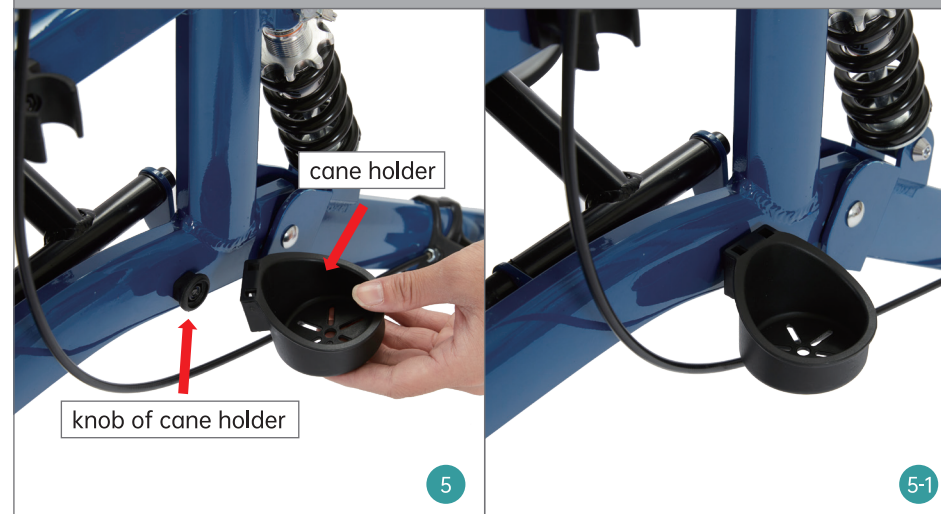

STEP 6 Cup Holder Assembly

Insert cup holder into the groove (fig 6, 6-1).



STEP 7 Hook and Loop Straps of Brake Cables Assembly

Affix the brake cable to the main frame with hook and loop strap (fig 7).



Transform Rollator into Transport Wheelchair

Step 1: flip over the backrest
Step 2: install the footrest

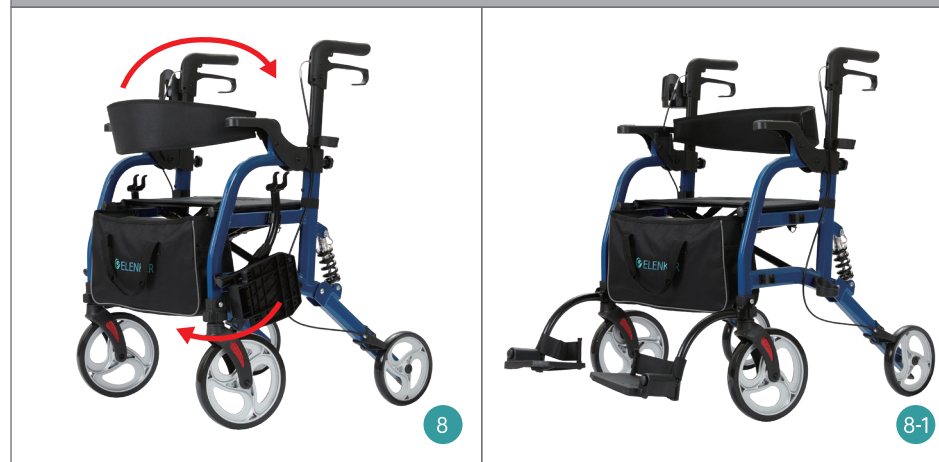

One-hand Folding

Pull up the strap of seat to fold the walker.



Handbrakes Operation

1. Squeeze to slow.
2. Push down to lock the rear wheel.



The Curb Climber

Use it to overcome obstacles such as curbs and thresholds.



HOW TO ADJUST BRAKES

Brake Issue: The brake cannot engage rear wheel when squeezing handbrake (fig A).



Adjust Rear Brake Position

Tools: Plier or 10mm wrench (fig 1).
Use plier(or 10mm wrench) to turn M6 nut counter-clockwise(fig 2-3). And brake will be closer to wheel(fig 4). Then squeeze handbrake, if it doesn't work, repeat the steps until rear brake can engage wheel.

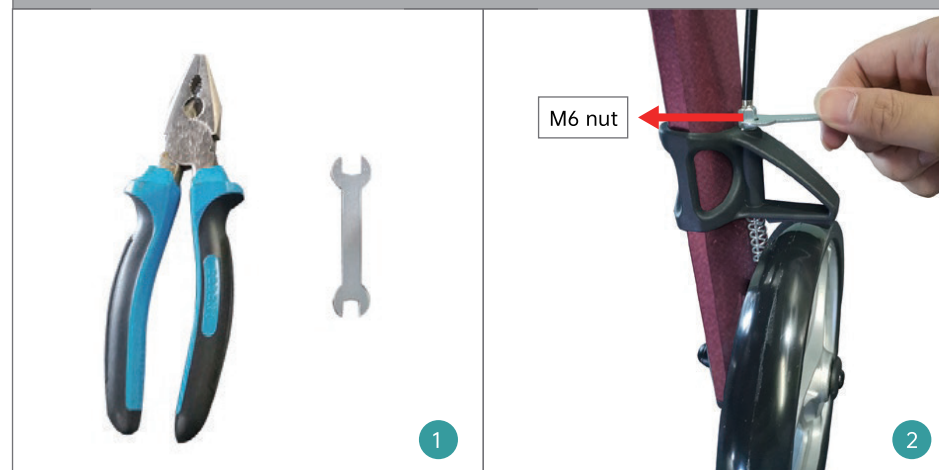

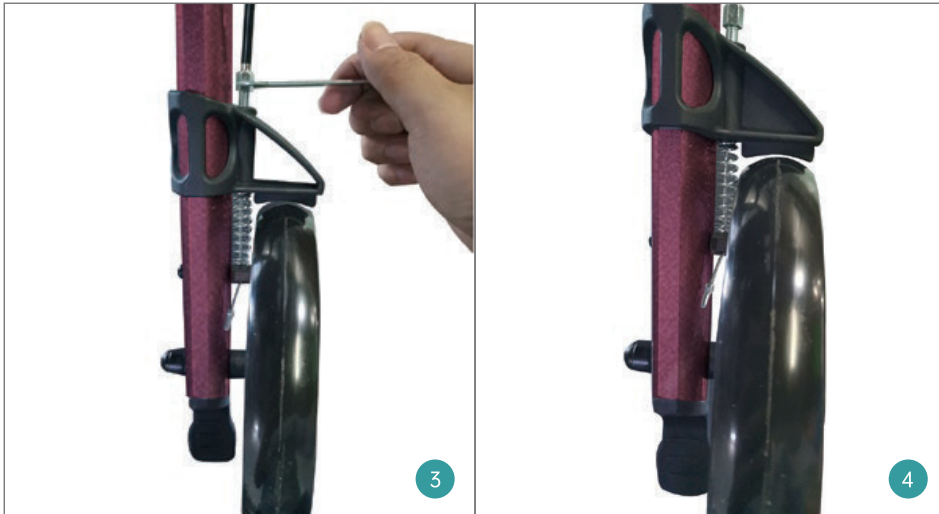

CONTACT US

For any defects, parts missing, use or repair concerning our products, please contact us first, our customer service will reply within 24 hours and offer a good solution. Thank you for your support.





1. E-mail: elenkerservice@hotmail.com
2. Amazon Message: Click the Sold by "store name" under the buy box, then "ask a question". (Amazon Buyer)
3. Customer Help Line: 800-513-5727

WARRANTY

- * You may return most new, unopened items sold and fulfilled by Amazon within **30** days of delivery for a full refund.
- * Defects in material accessories and non-durable components such as wheels, brakes, seat, handgrips and under NORMAL use for the **lifetime** warranty of the original consumer purchaser.
- * The warranty does not extend to device failure due to owner misuse or negligence, or normal wear, tear and need periodic replacement.
- * During warranty periods, our warranties cover all parts labor and shipping for repairing this walker.

WARNINGS

To ensure your safety in using ELENKER Rollator Walker, all the following instructions must be followed

-  The maximum load of the walker is 300lbs.
-  DO NOT use walker, if there is apparent damage or if any parts are missing.
-  Ensure that brakes, height adjustment bolts or any other moving parts are in good condition and check all screws and fasteners, and retighten if necessary.
-  DO NOT use on stairs, escalators, moving sidewalks, or go up or down inclines greater than 15% or diagonally across inclines greater than 5%.
-  Be careful to avoid pinching your fingers while raising and lowering the handle bar and opening and closing the rollator walker frame.