



E L E

N K

E R

YF-9006A
ROLLATOR
WALKER

YF-9006A
ROLLATOR
WALKER



USER MANUAL

Parts:







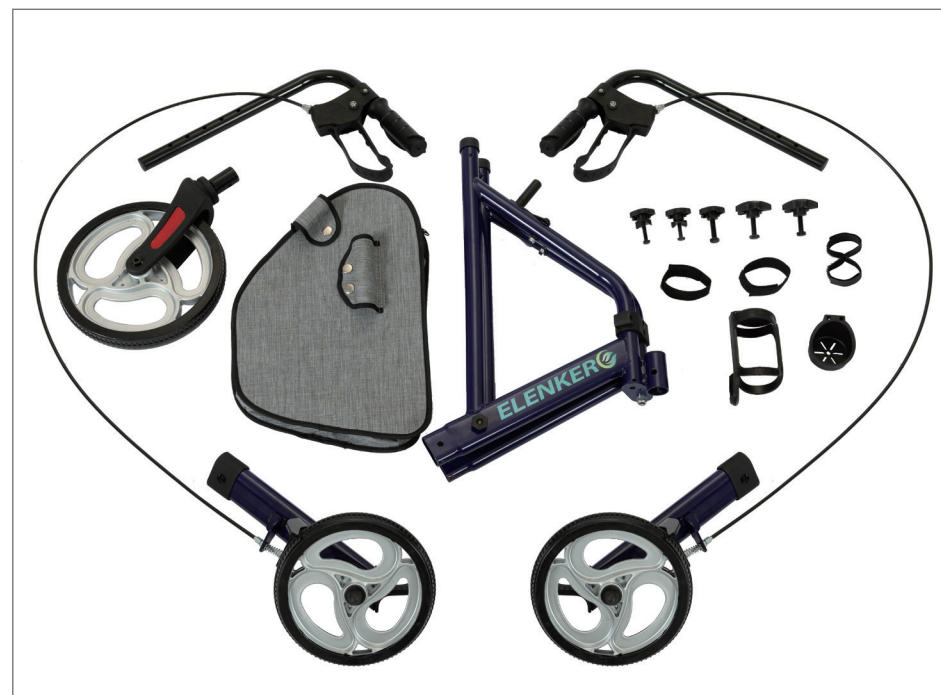

- | | |
|--------------------------------------|----------------------------------|
| 1 Handgrip | 7 8" rear wheel |
| 2 Handbrake | 8 Cup holder |
| 3 Small bolt and nut | 9 Quick-collapse lever |
| 4 Storage bag | 10 Big bolt and nut |
| 5 Cane holder | 11 10" front wheel |
| 6 Hook and loop strap of brake cable | 12 Open ends hook and loop strap |

SET-UP INSTRUCTIONS



ACCESSORIES LIST

- | | | | |
|---|---|---|---|
|  | 2x Short bolts washers, and nuts of handle bars |  | 2x Hook and loop straps of brake cables |
|  | 2x Long bolts and nuts of legs |  | 1x Open ends hook and loop strap |
|  | 1x Long bolt and nut of front wheel |  | 1x Cane holder |
|  | 1x Cup holder | | |

STEP 1

Front Wheels Assembly

Open the main frame(fig 1), insert front wheel into the main frame(fig 1-1), then secure it with long bolt and nut(fig 1-2,1-3).

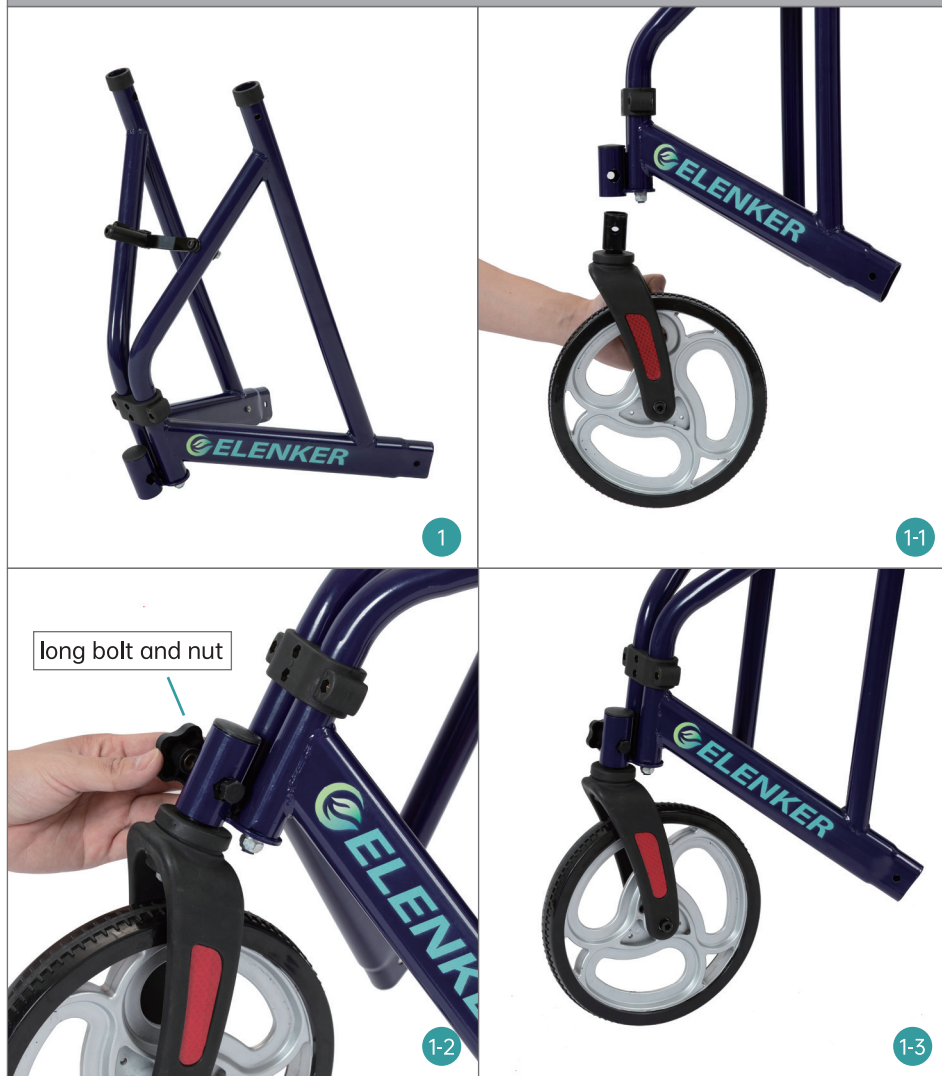

STEP 2

Rear Wheels Assembly

Insert rear wheel leg into the main frame(fig 2), then secure it with long bolt and nut(fig 2-1,2-2). Repeat the same steps on the other side(fig 2-3)(There are labels on each tube "L-L,R-R").



STEP 3

Handle Bars Assembly

Insert handle bar tube into the main frame(fig 3), then secure it with short bolt and nut(fig 3-1,3-2), repeat the same steps on the other side(fig 3-3).



STEP 4

Storage Bag Assembly

Affix storage bag to the main frame with snap buttons(fig 4,4-1).

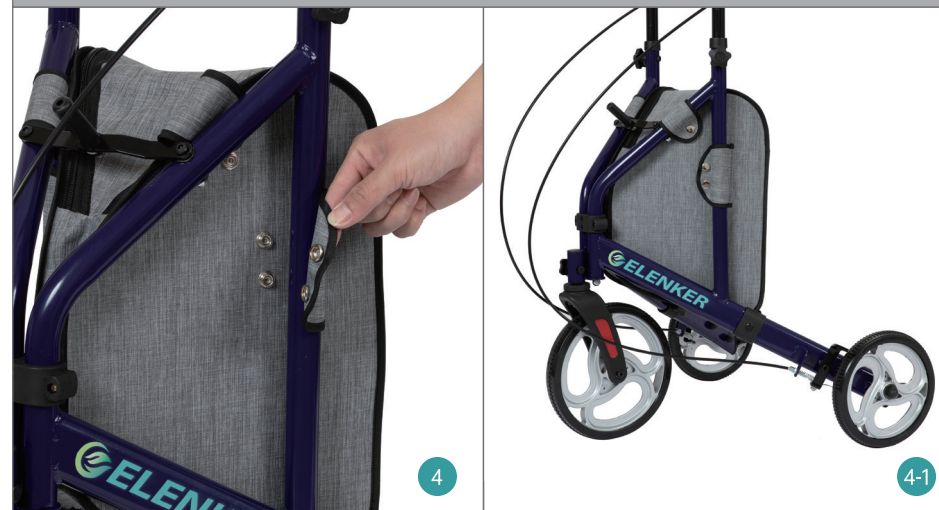

STEP 5

Cane Holder Assembly

Cane knob is on the rear wheel leg, insert cane holder into cane knob(fig 5,5-1). Affix open ends hook and loop strap of cane to right handle bar(fig 5-2).

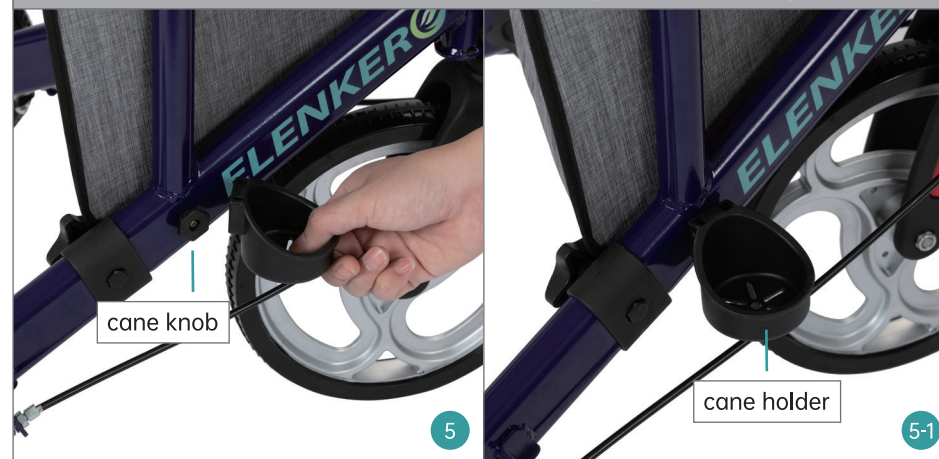

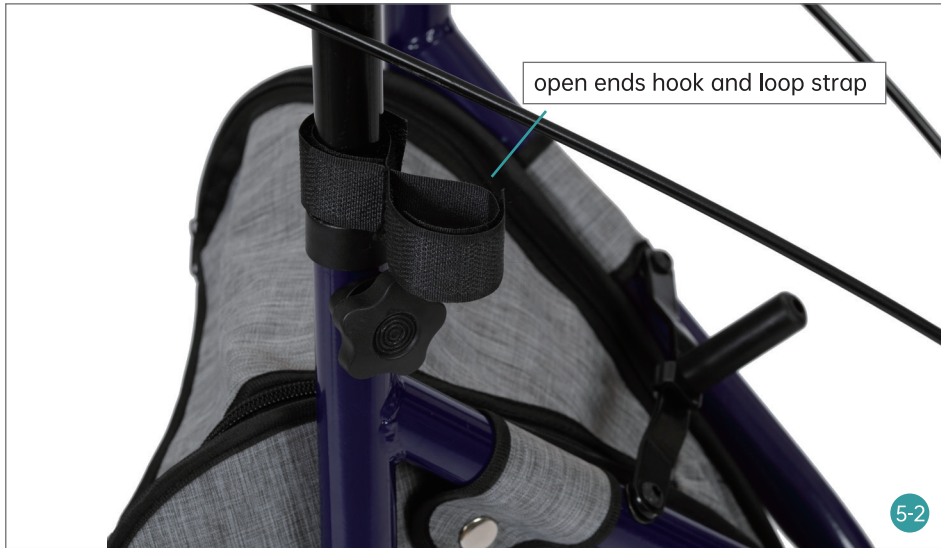

STEP 6 Organize Brake Cable

Affix brake cable to the main frame with hook and loop strap(fig 6,6-1).



STEP 7 Cup Holder Assembly

Cup holder knob is on the left handle bar, insert cup holder into cup holder knob(fig 7, 7-1),

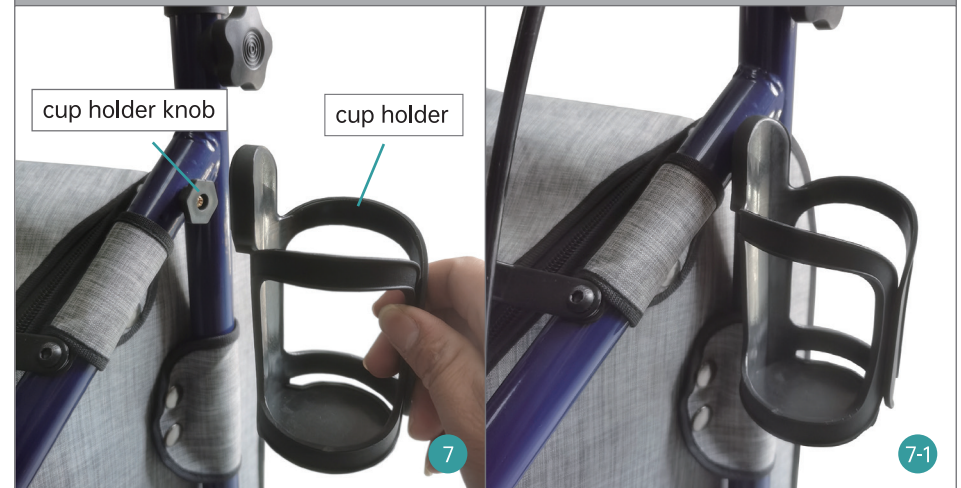

THE CURB CLIMBER

Use it to overcome obstacles such as curbs and thresholds.



ONE-HAND FOLDING

Pull the quick-collapse lever back to fold it.



HANDBRAKES OPERATION

1. Squeeze to slow
2. Push down to lock the rear wheels

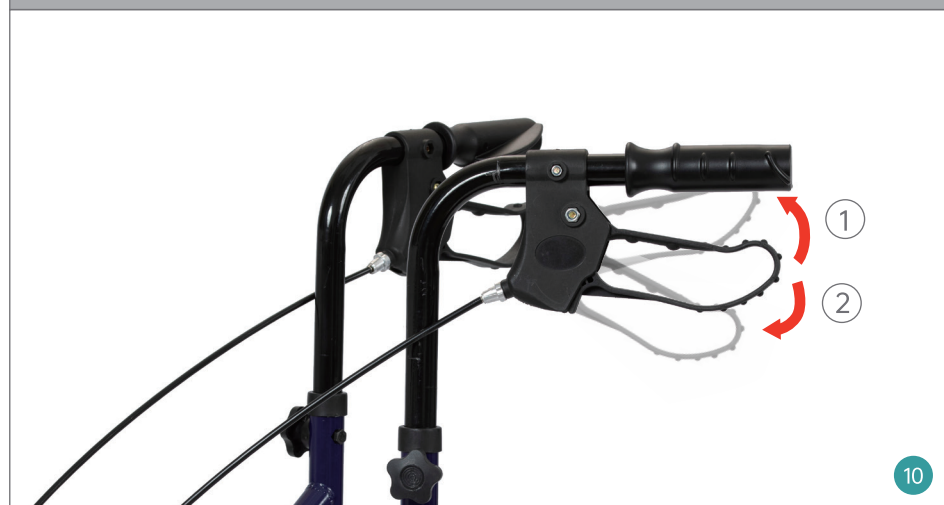

HOW TO ADJUST BRAKES

1. Press the handgrip down (fig 1,2)

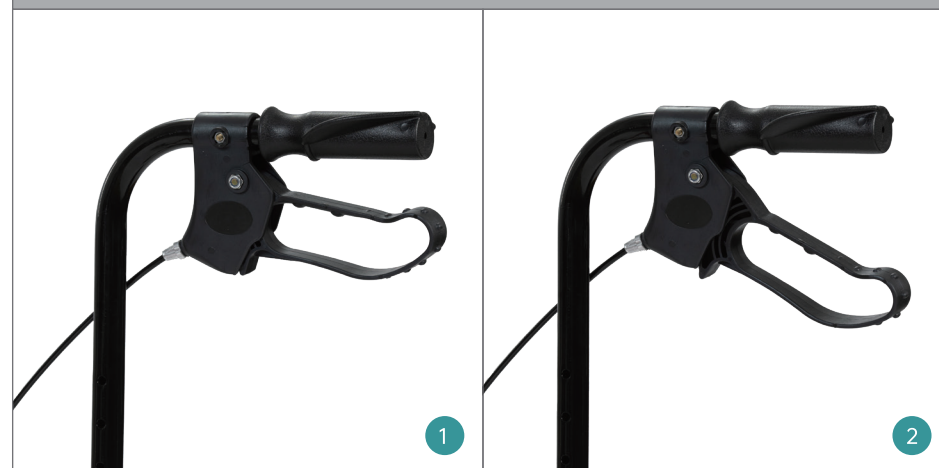

2. The rear brake cannot engage rear wheel when pressing the handgrip down. (fig 3)
3. One hand hold the screw holder, and turn the screw housing left or right (fig 4,5) until rear brake can engage the rear wheel (fig 6).

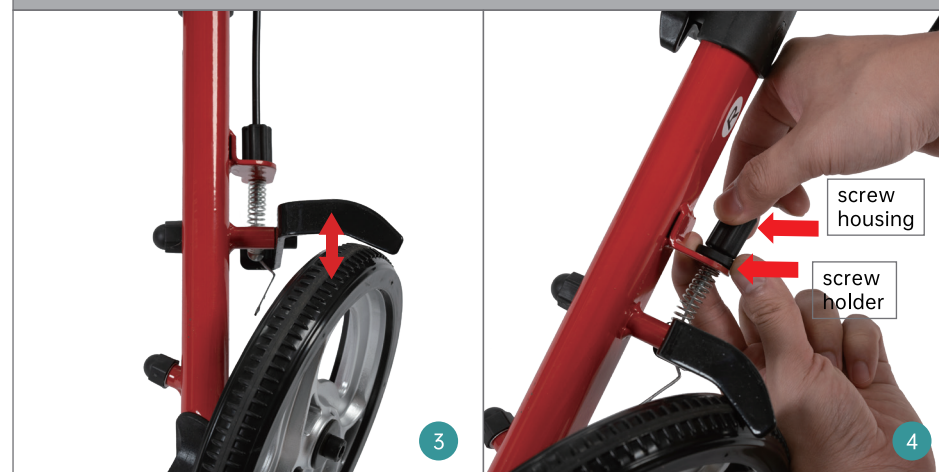



CONTACT US

For any defects, parts missing, use or repair concerning our products, please contact us first, our customer service will reply within 24 hours and offer a good solution. Thank you for your support.

1. E-mail: elenkerservice@hotmail.com
2. Amazon Message: Click the Sold by "store name" under the buy box, than "ask a question".(Amazon Buyer)
3. Customer Help Line: (800) 401-7769

WARRANTY

You may return most new, unopened items sold and fulfilled by Amazon within **30** days of delivery for a full refund.

Defects in material accessories and non-durable components such as wheels, brakes, handgrips and under NORMAL use for the **lifetime** warranty of the original consumer purchaser.

The warranty does not extend to device failure due to owner misuse or negligence, or normal wear, tear and need periodic replacement.

During warranty periods, our warranties cover all parts labor and shipping for repairing this walker.

⚠ WARNINGS

To ensure your safety in using ELENKER Rollator Walker, all the following instructions must be followed

⚠ The maximum load of the walker is 500lbs.

⚠ DO NOT use walker, if there is apparent damage or if any parts are missing.

⚠ Ensure that brakes, height adjustment bolts or any other moving parts are in good condition and check all screws and fasteners, and retighten if necessary.

⚠ DO NOT use on stairs, escalators, moving sidewalks, or go up or down inclines greater than 15% or diagonally across inclines greater than 5%.

⚠ Be careful to avoid pinching your fingers while raising and lowering the handle bar and opening and closing the rollator walker frame.