



E L E

N K

E R

YF-9008F
ROLLATOR
WALKER



YF-9008F
ROLLATOR
WALKER



USER MANUAL

Parts:



- | | |
|---------------------------------------|---|
| 1 Handbrake | 9 Armrest Pad |
| 2 Cup Holder | 10 Open Ends Hook and Loop Strap |
| 3 Backrest | 11 Bolt and Nut for Handle Bar |
| 4 Hook and Loop Strap for Brake Cable | 12 Sit-to-stand Handle Bar |
| 5 Padded Seat | 13 Bolt and Nut for Sit-to-stand Handle Bar |
| 6 Under-seat Basket | 14 Cane Holder |
| 7 Front Wheel | 15 Rear Wheel |
| 8 Handgrip | |







SET-UP INSTRUCTIONS

STEP 1

Unbox the walker on a level floor.



Accessories

- | | | | |
|---|---|---|--|
|  | 1x Cane holder |  | 1x Cup holder |
|  | 1x Open ends hook and loop strap to secure the upper part of cane |  | 2x Hook and loop straps for brake cables |
|  | 2x Bolts Washers and Small Nuts(for sit-to-stand handle bars) |  | 2x Bolts and Big Nuts(for handle bars) |

STEP 2

Seat Assembly

Place the seat on the main frame with seat clip, there are two anti-slip stoppers to prevent the seat sliding, please make sure the clips are on the outside of the anti-slip stoppers(fig 2, 2-1, 2-2).



STEP 3

Front Wheels Assembly

Press spring button of wheel's leg, then insert it into the main frame(fig 3,3-1). The same steps to assemble right front wheel's leg(there are labels on legs and the main frame "L1-L1 R1-R1")(fig 3-2).

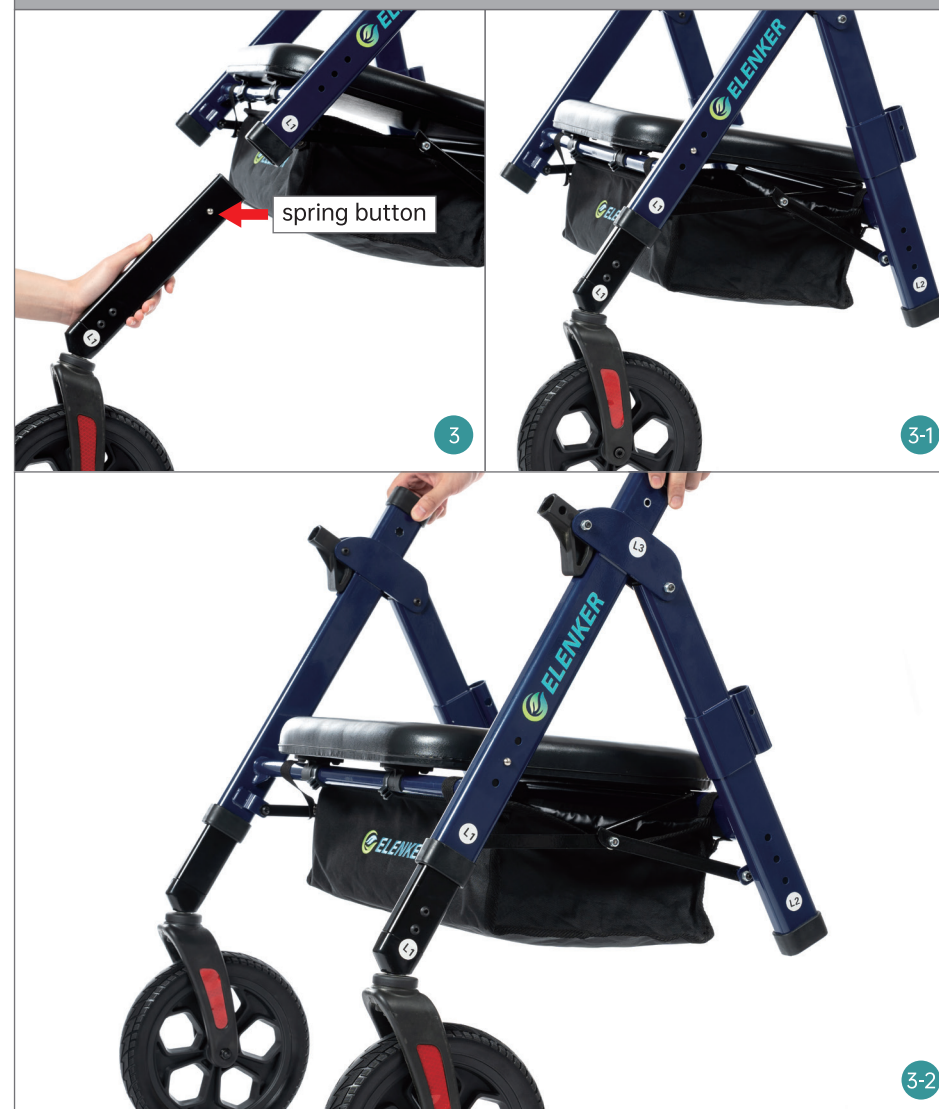

STEP 4

Rear Wheels Assembly

Press spring button of wheel's leg, then insert it into the main frame(fig 4,4-1). The same step to assemble right rear wheel's leg(there are labels on legs and the main frame "L2-L2 R2-R2")(fig 4-2).



STEP 5

Handle Bar Assembly

Insert the handle bar tube into the main frame(fig 5), then secure it with bolt and big nut(fig 5-1 5-2). The same step to assemble right handle bar tube (there are labels on tubes and the main frame "L3-L3 R3-R3")(fig 5-3).



STEP 6

The Handgrip Assembly

Insert the handgrip tube into the armrest pad tube(fig 6), adjust length and angle to fit your forearm, then secure it by closing the handgrip clamp lever (fig 6-1, 6-2).

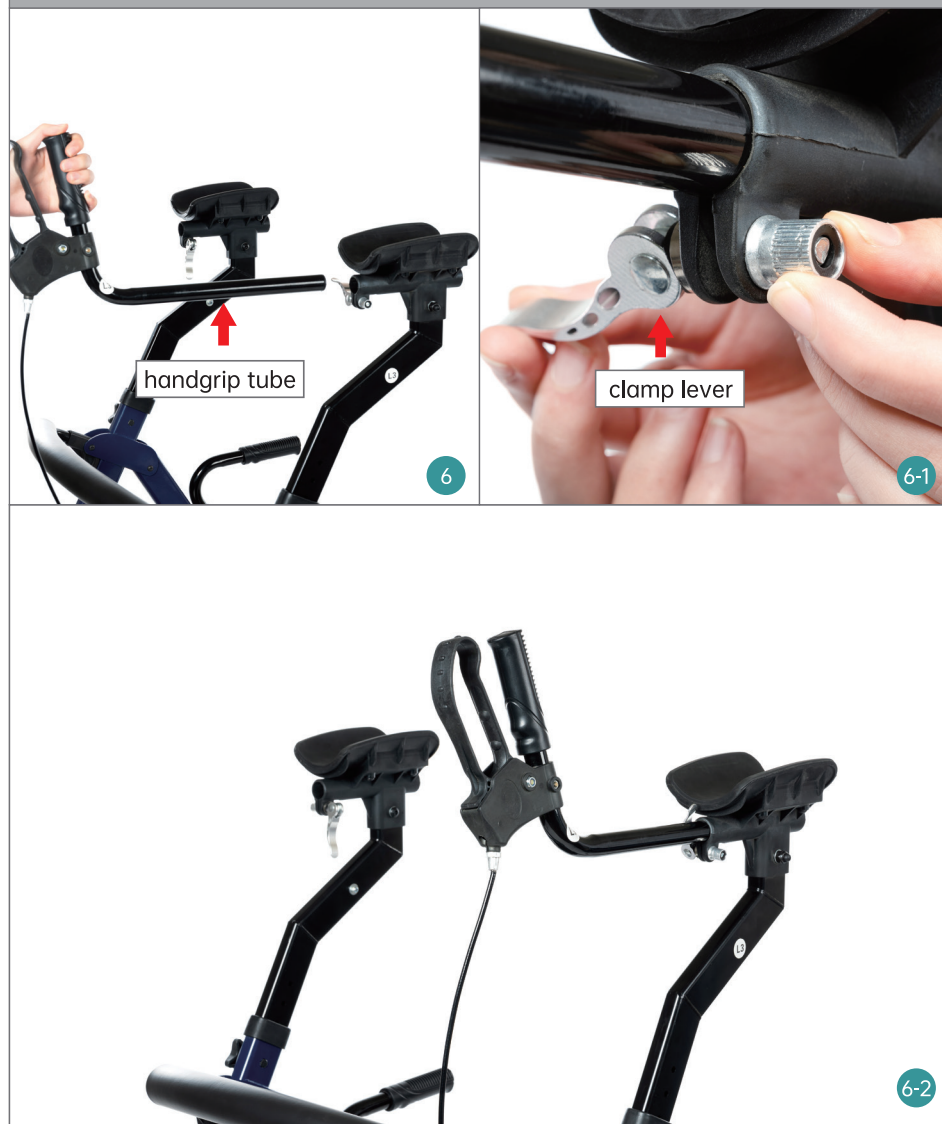

STEP 7

Backrest Assembly

Insert backrest into the main frame(fig 7, 7-1).



STEP 8

Sit-to-stand Handle Bar Assembly

Insert the sit-to-stand handle bar(fig 8), secure it with bolts, washer and small nut(fig 8-1, 8-2, 8-3).

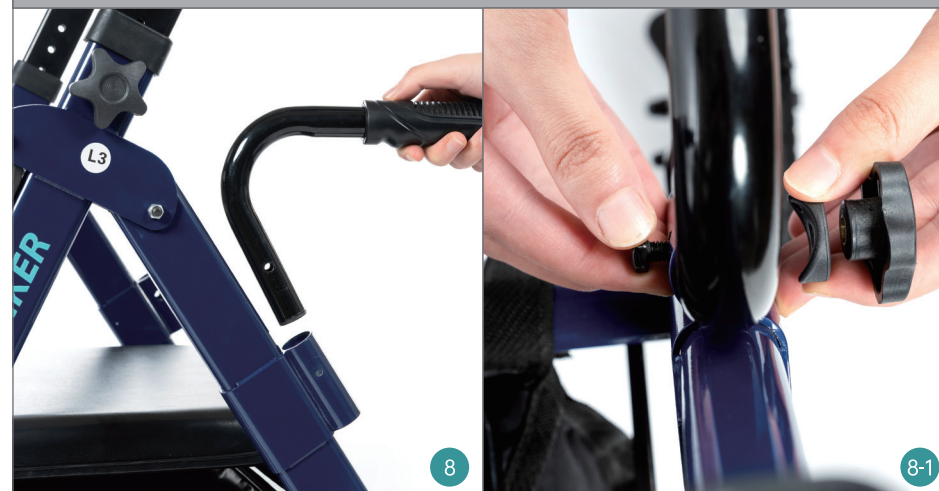

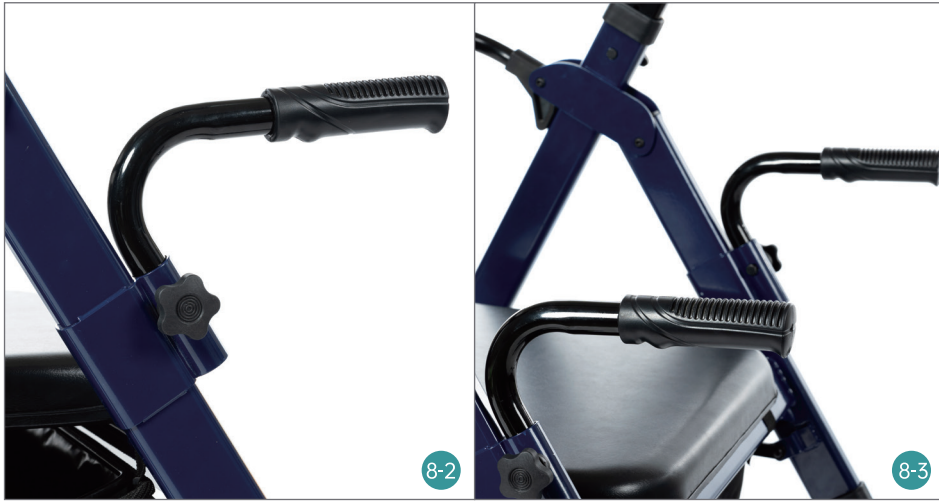

STEP 9 Brake Cable Hook and Loop Strap Assembly

Affix the brake cable to the main frame with hook and loop strap(fig 9).



STEP 10 Cane/Umbrella Holder Assembly

Insert cane holder into cane holder knob (cane holder knob is on the right leg tube)(fig 10, 10-1). Then affix the "8" shpae hook and loop strap for securing the upper part of cane(fig 10-2).



STEP 11

Cup Holder Assembly

There is a cup knob on the handle bar(fig 11), insert cup holder into cup knob (fig 11-1) .



The Curb Climber

Use it to overcome obstacles such as curbs and thresholds.



HANDBRAKES OPERATION

1. Squeeze to slow
2. Push down to lock the rear wheels



ONE-HAND FOLDING

Pull up the under-seat bracket to fold the walker.

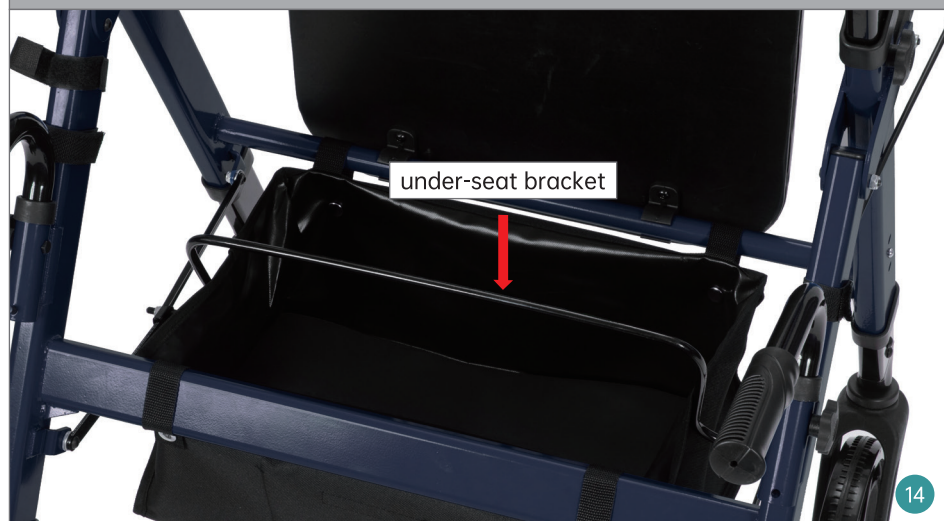

HOW TO ADJUST BRAKES

There are two ways to fix it.

A: Adjust the screw housing.

1. Press the handgrip down (fig 1,2).

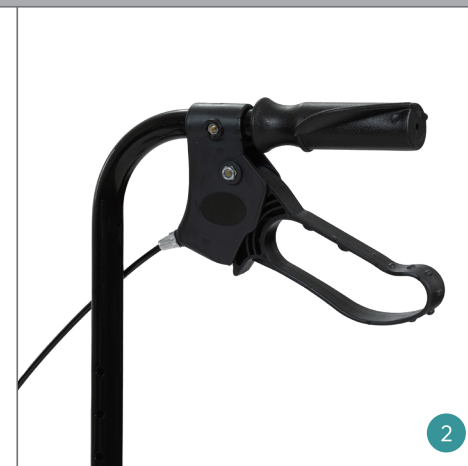
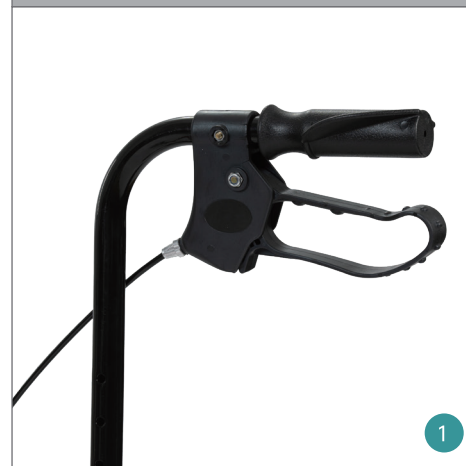

2. The rear brake cannot engage rear wheel when pressing the handgrip down. (fig 3);

3. One hand hold the screw holder, and turn the screw housing left or right (fig 4,5) until rear brake can engage the rear wheel (fig 6).

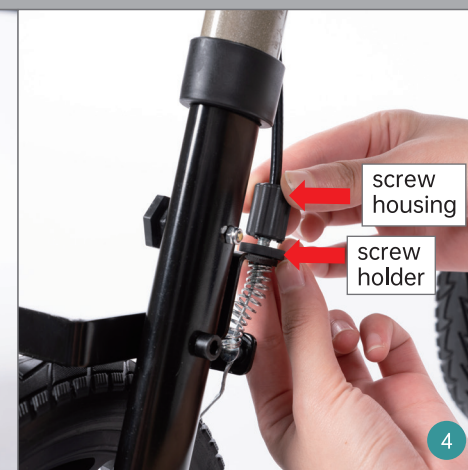
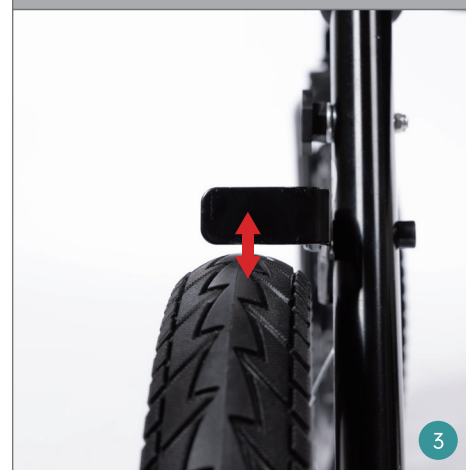

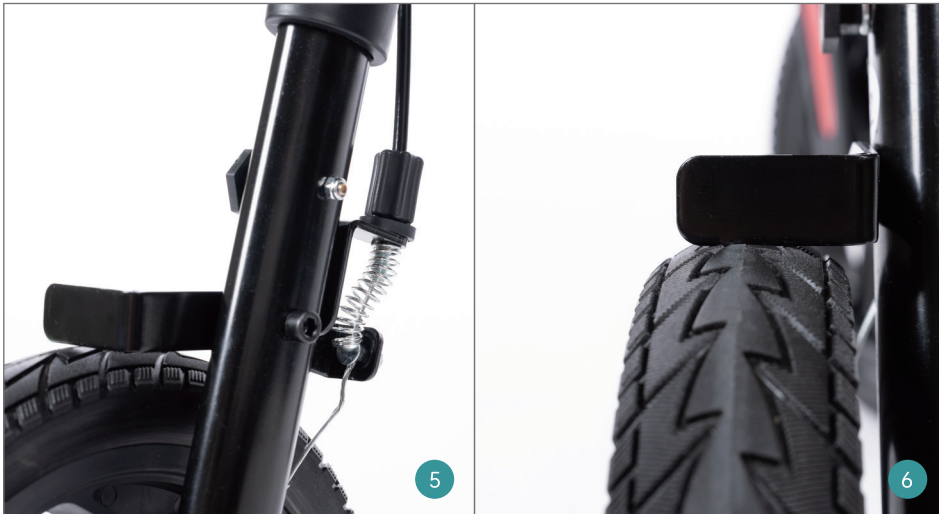

B: If method one doesn't work, please tighten the brake cable.

1. Press the handgrip down (fig 1,2).

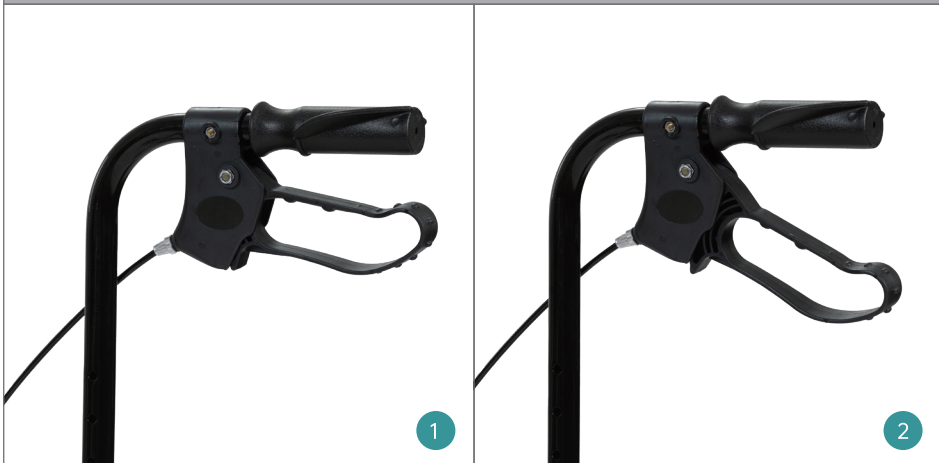

2. Loosen the screw, the spring will become loose, and the rear brake will loosen;
 3. Use pliers to pull the brake cable while bringing the rear brake close to the wheel, then tighten the screw;
 4. Put the handbrake to its original position, the wheel should be able to roll. Press the handbrake down or squeeze the handbrake, and the rear brake should come close to the wheel, indicating a successful adjustment.









WARRANTY

- * You may return most new, unopened items sold within 30 days of delivery for a full refund.
- * Defects in material accessories and non-durable components such as wheels, brakes, seat, and handgrips under normal use are covered for the 3-year warranty of the original consumer purchaser.
- * The warranty does not extend to device failure due to owner misuse or negligence, or normal wear, tear and need periodic replacement.

WARNINGS

To ensure your safety in using ELENKER Rollator Walker, all the following instructions must be followed.

-  The maximum load of the walker is 500lbs.
-  DO NOT use walker, if there is apparent damage or if any parts are missing.
-  Ensure that brakes, height adjustment bolts or any other moving parts are in good condition and check all screws and fasteners, and retighten if necessary.
-  DO NOT use on stairs, escalators, moving sidewalks, or go up or down inclines greater than 15% or diagonally across inclines greater than 5%.
-  Be careful to avoid pinching your fingers while raising and lowering the handle bar and opening and closing the rollator walker frame.
-  The rollator walker is intended to provide additional help and support, but is not a substitute for medical treatment or rehabilitation. Please use it correctly under the guidance of professionals, and keep the accessories properly to avoid misuse or damage.

CONTACT US

For any defects, parts missing, use or repair concerning our products, please contact us first, our customer service will reply within 24 hours and offer a good solution. Thank you for your support.

1. E-mail: elenkerservice@hotmail.com
2. Amazon Message: Click the Sold by "store name" under the buy box, then "ask a question". (Amazon Buyer)
3. Customer Help Line: (800) 401-7769